

ASSEMBLY INSTRUCTIONS

(See reverse page for Heavy Duty Cart)

CAUTION

INSPECT CONTENTS IMMEDIATELY AND FILE CLAIM WITH DELIVERING CARRIER FOR ANY DAMAGE. **SAVE BOX AND ALL PACKING MATERIALS.** YOU ARE RESPONSIBLE FOR DAMAGE TO YOUR UNIT IF RETURNED IMPROPERLY PACKED.

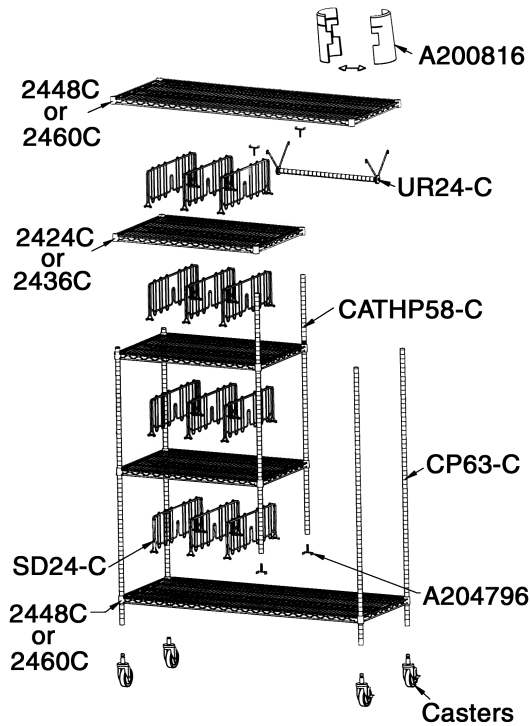

Parts List 24" x 48"

qty	part number	qty	part number
4	CP63-C	2	CATHP58-C
12	R63-C	8	SD24-C
1	UR24-C	3	.2424C
2	2448	5	A200816 (set of 4)
5	A204331	4	A204796 clip

Parts List 24" x 60"

qty	part number	qty	part number
4	CP63-C	2	CATHP58-C
12	R63-C	12	SD24-C
1	UR24-C	3	.2436C
2	2460C	5	A200816 (set of 4)
16	A204331	4	A204796 clip

1) Casters & First Shelf

Insert casters into posts. Assemble split sleeves on the first groove found on the bottom of the post. The split sleeves snap together around the posts. The wider end of the split sleeve faces the bottom of the assembly. Lower first shelf on posts until split sleeves rest snugly in the shelf collars.

2) Second & Third Shelves

Screw two clips to the bottom of the middle posts. Assemble split sleeves on the left end posts and middle posts at desired location for second shelf. Be sure that the grooves the sleeves snap into are evenly across from each other. Lower shelf down onto left end posts and middle posts until split sleeves rest snugly in the shelf collars. Rest clips on the first shelf.

Repeat for third shelf.

Note: The recommended height between each shelf is about 14"-15".

3) Fourth & Fifth Shelves

Assemble split sleeves on left and middle posts at desired location for fourth shelf. Lower shelf down onto left end posts and middle posts until split sleeves rest snugly in the shelf collars. Screw the clips to the top of the middle posts. Be sure that the clips are the same direction as the bottom ones. Assemble split sleeves on the top groove of the end and middle posts. Lower fifth shelf onto left end and right end posts until split sleeves rest snugly in shelf collars.

4) Dividers

Insert divider clip into rear of shelf. Push front of divider to spring close and release with clip capturing front of wire shelf. Please note that it may take some force to install divider. Install three dividers per shelf.

5) Uniform Rack

Bolt, on both ends of the post, the washers and hooks together in the following order: washer, hook, washer and bolt.

6) Rods

Place clip over shelf edge so that the flat (solid) part of the clip is vertical and the clip has the rod between the prongs. See the picture to the right.

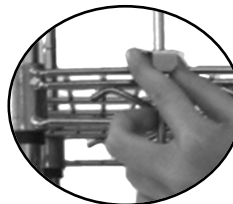

(End)

EG9877 Revised 01/24

Patient Article Cart—Heavy Duty

ASSEMBLY INSTRUCTIONS

(See reverse page for Standard Cart)

CAUTION

INSPECT CONTENTS IMMEDIATELY AND FILE CLAIM WITH DELIVERING CARRIER FOR ANY DAMAGE. **SAVE BOX AND ALL PACKING MATERIALS.** YOU ARE RESPONSIBLE FOR DAMAGE TO YOUR UNIT IF RETURNED IMPROPERLY PACKED.

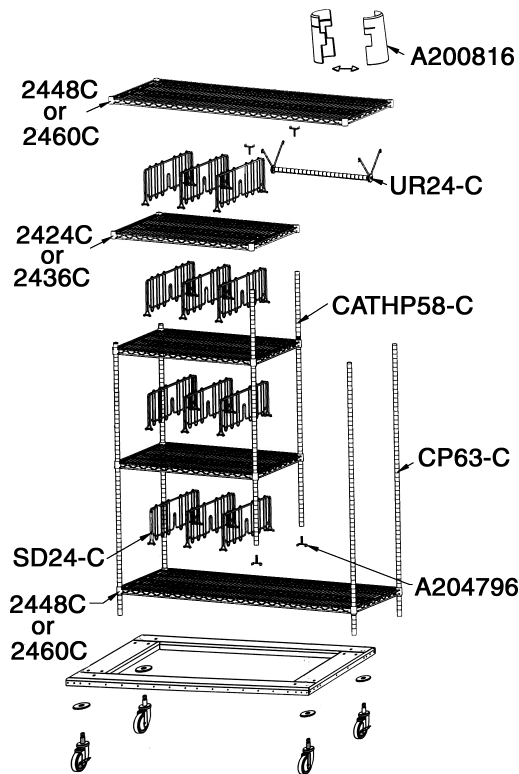

Parts List 24" x 48"

qty	part number	qty	part number
4	CP63-C	2	CATHP58-C
12	R63-C	8	SD24-C
1	UR24-C	3	2424C
2	2448	5	A200816 (set of 4)
5	A204331	4	A204796 clip

Parts List 24" x 60"

qty	part number	qty	part number
4	CP63-C	2	CATHP58-C
12	R63-C	12	SD24-C
1	UR24-C	3	2436C
2	2460C	5	A200816 (set of 4)
16	A204331	4	A204796 clip

1) Four Outside Posts and First Shelf

Line up the four outside posts with the four holes on the truck dolly. From underneath the truck dolly insert the hex head bolt into the post and tighten. Assemble plastic split sleeves on the posts so that the number 3 is showing above all. Lower shelf down onto posts until split sleeves rest snugly in the shelf collars.

2) Second & Third Shelves

Screw two clips to the bottom of the middle posts. Assemble split sleeves on the left end posts and middle posts at desired location for second shelf. Be sure that the grooves the sleeves snap into are evenly across from each other. Lower shelf down onto left end posts and middle posts until split sleeves rest snugly in the shelf collars. Rest clips on the first shelf.

Repeat for third shelf.

Note: The recommended height between each shelf is about 14"-15".

3) Fourth & Fifth Shelves

Assemble split sleeves on left and middle posts at desired location for fourth shelf. Lower shelf down onto left end posts and middle posts until split sleeves rest snugly in the shelf collars. Screw the clips to the top of the middle posts. Be sure that the clips are the same direction as the bottom ones. Assemble split sleeves on the top groove of the end and middle posts. Lower fifth shelf onto left end and middle posts until split sleeves rest snugly in shelf collars.

4) Dividers

Insert divider clip into rear of shelf. Push front of divider to spring close and release with clip capturing front of wire shelf. Please note that it may take some force to install divider. Install three dividers per shelf.

5) Uniform Rack

Bolt, on both ends of the post, the washers and hooks together in the following order: washer, hook, washer and bolt.

6) Rods

Place clip over shelf edge so that the flat (solid) part of the clip is vertical and the clip has the rod between the prongs. See the picture to the right.

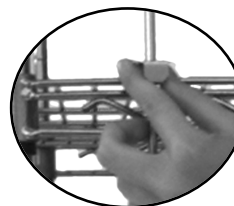

(End)