

# Inhalation Therapy Cart

## ASSEMBLY INSTRUCTIONS

### CAUTION

INSPECT CONTENTS IMMEDIATELY AND FILE CLAIM WITH DELIVERING CARRIER FOR ANY DAMAGE. **SAVE YOUR BOX AND ALL PACKING MATERIALS.** YOU ARE RESPONSIBLE FOR DAMAGE TO YOUR UNIT IF RETURNED IMPROPERLY PACKED.

### Parts List

#	qty	part #	description	#	qty	part #	description
#1	2	B200054	"U" handles/legs	#6	4	A201162	casters
#2	2	B201032	cylinder rack matt	#7	4	A201163	casters with brake
#3	2	B201389	cylinder rack truss frame	#8	12	A200022	pairs of aluminum split sleeves
#4	1	B200692	wire shelf	#9	12	A200021	retaining rings
#5	4	A200019	donut bumpers				

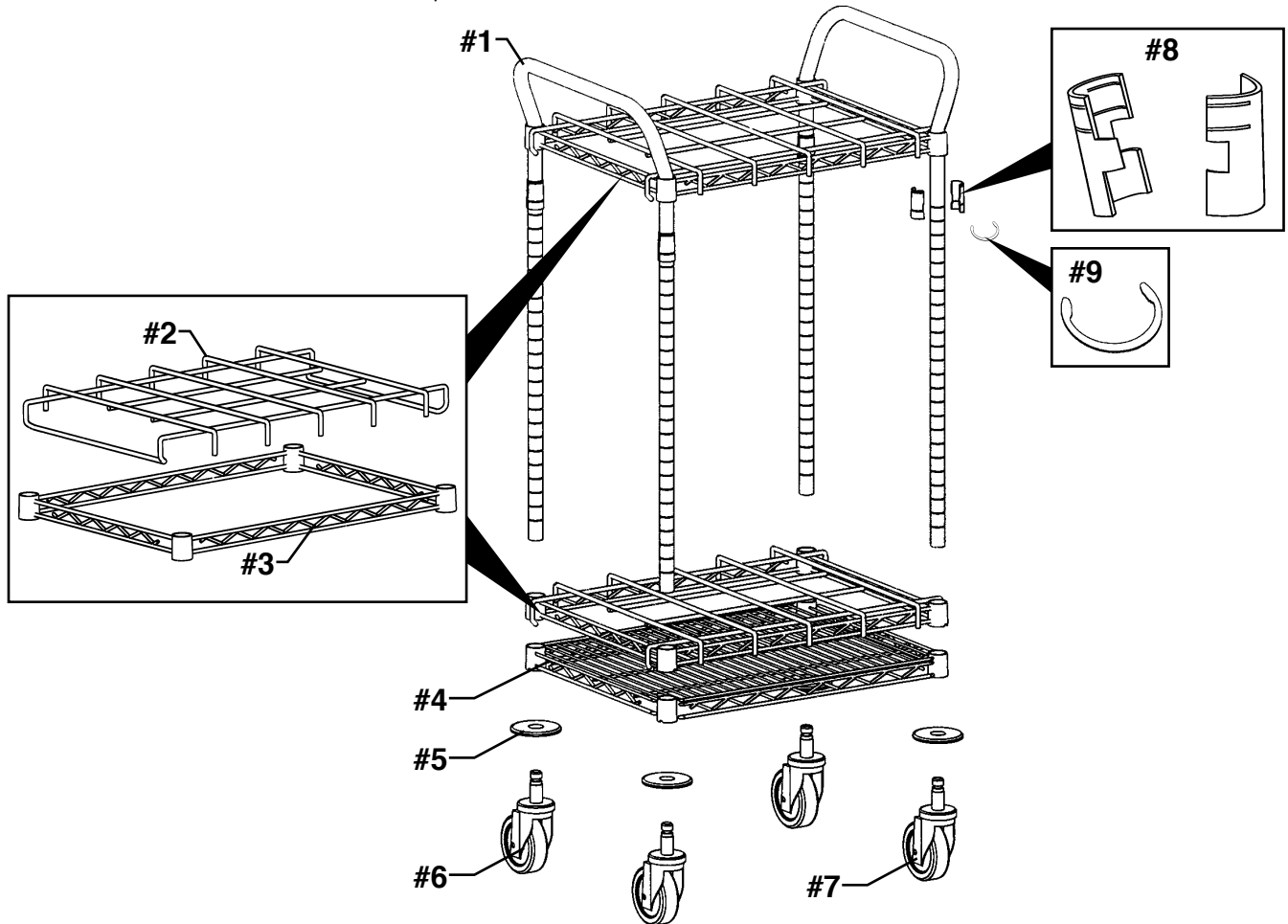

### Before assembly, please note:

- Do NOT install casters before installing shelves.
- "U" handles' legs must be straight and parallel for easy assembly. If they have been bent in shipping and handling, straighten them now.
- When installing racks and shelves, make sure the thicker part of the collars goes toward the bottom.

(continued on Page 2)

EG9821 Revised 10/23

# Inhalation Therapy Cart

## ASSEMBLY INSTRUCTIONS

### Step 1 - Attach top cylinder rack truss frame to "U" handles/legs.

- Slide cylinder rack truss frame toward top of the handles.
- Attach aluminum split sleeves to top groove of "U" handles/legs.
- Slide cylinder rack truss frame down onto split sleeves.

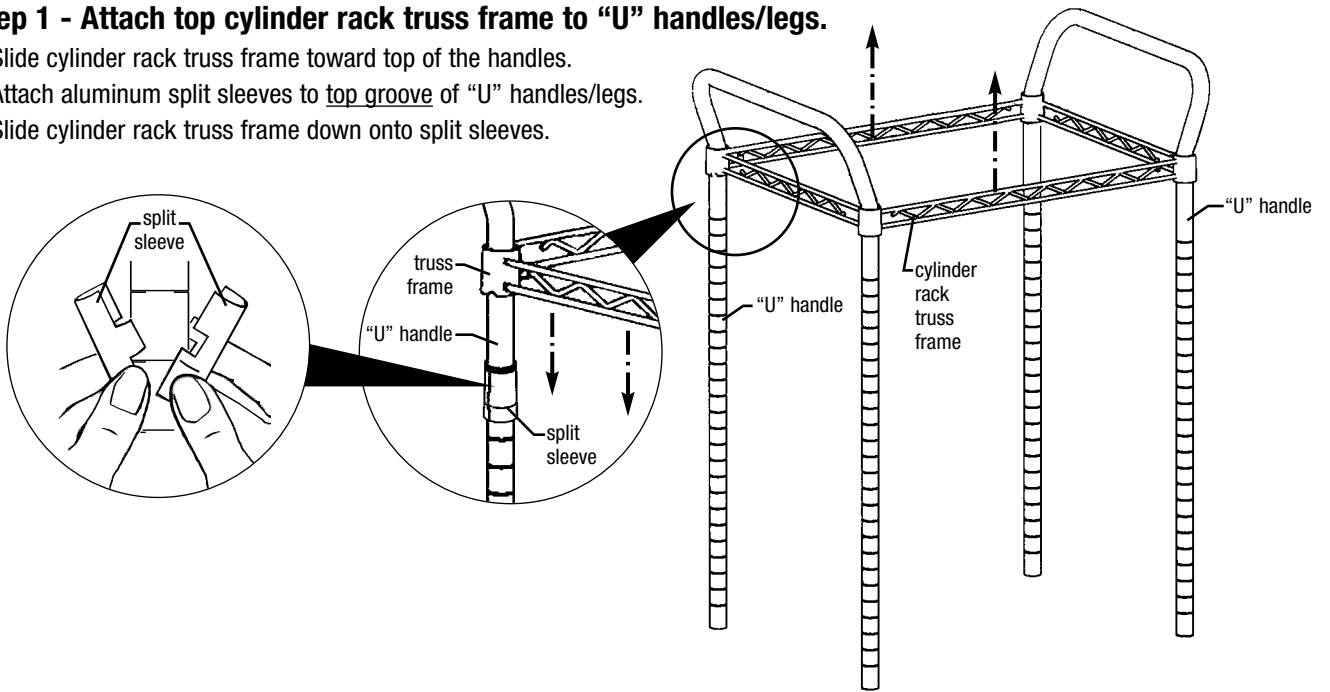

### Step 2 - Slide bottom cylinder rack truss frame and wire shelf up "U" handles/legs.

**IMPORTANT:** Slide bottom cylinder rack truss frame first, then slide wire shelf toward top of handles.

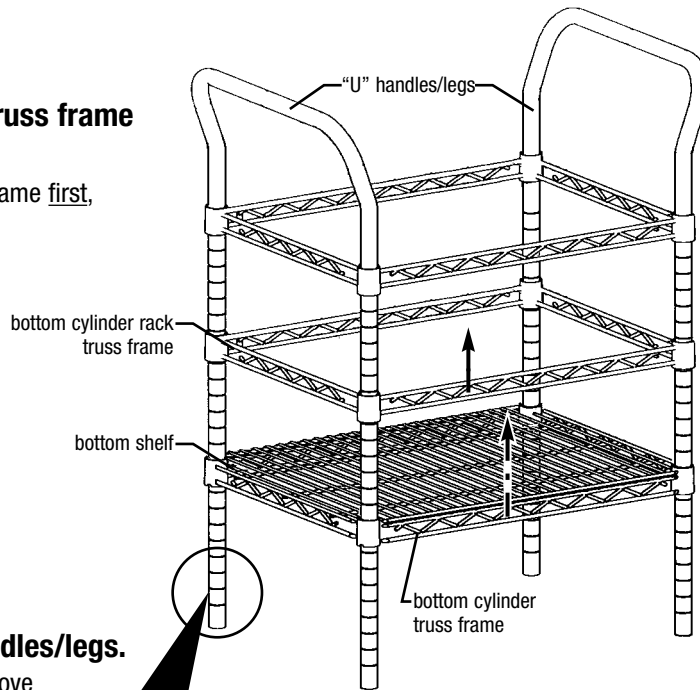

### Step 3 - Attach wire shelf to "U" handles/legs.

- Snap aluminum split sleeves onto bottom groove of "U" handles/legs.
- Slide wire shelf down onto split sleeves.

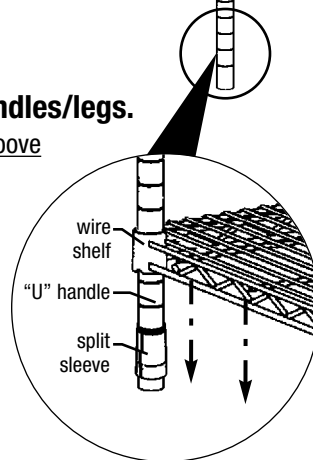

(continued on Page 3)

# Inhalation Therapy Cart

## ASSEMBLY INSTRUCTIONS

### Step 4 - Attach bottom cylinder rack truss frame to "U" handles/legs.

- Snap aluminum split sleeves onto 4th groove of "U" handles/legs.
- Slide cylinder rack truss frame down onto split sleeves.

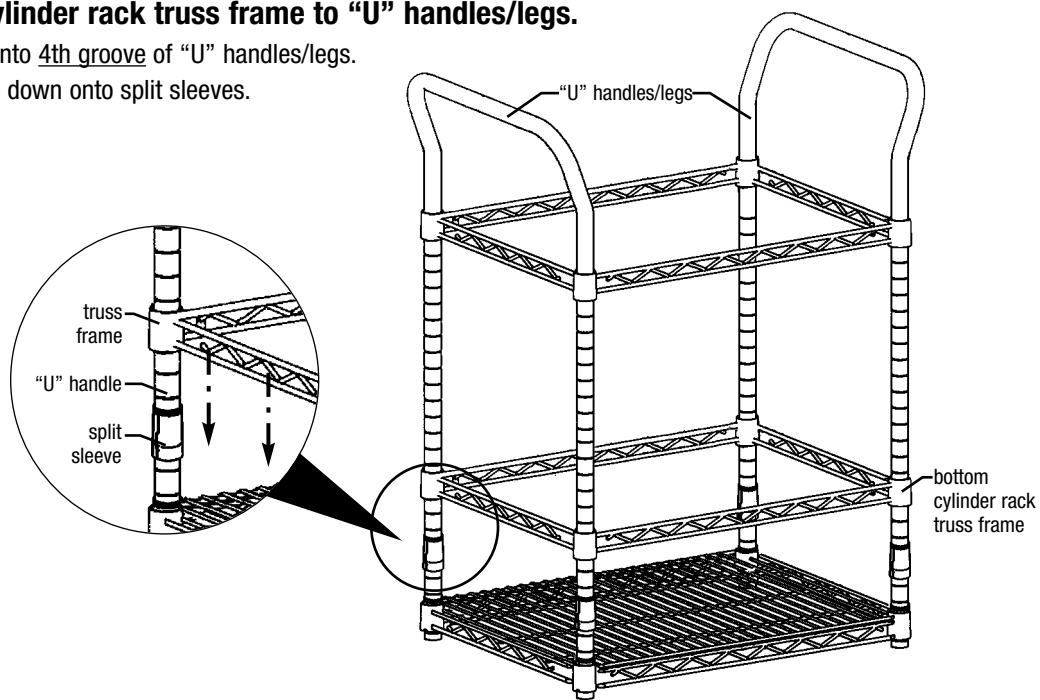

### Step 5 - Secure shelving.

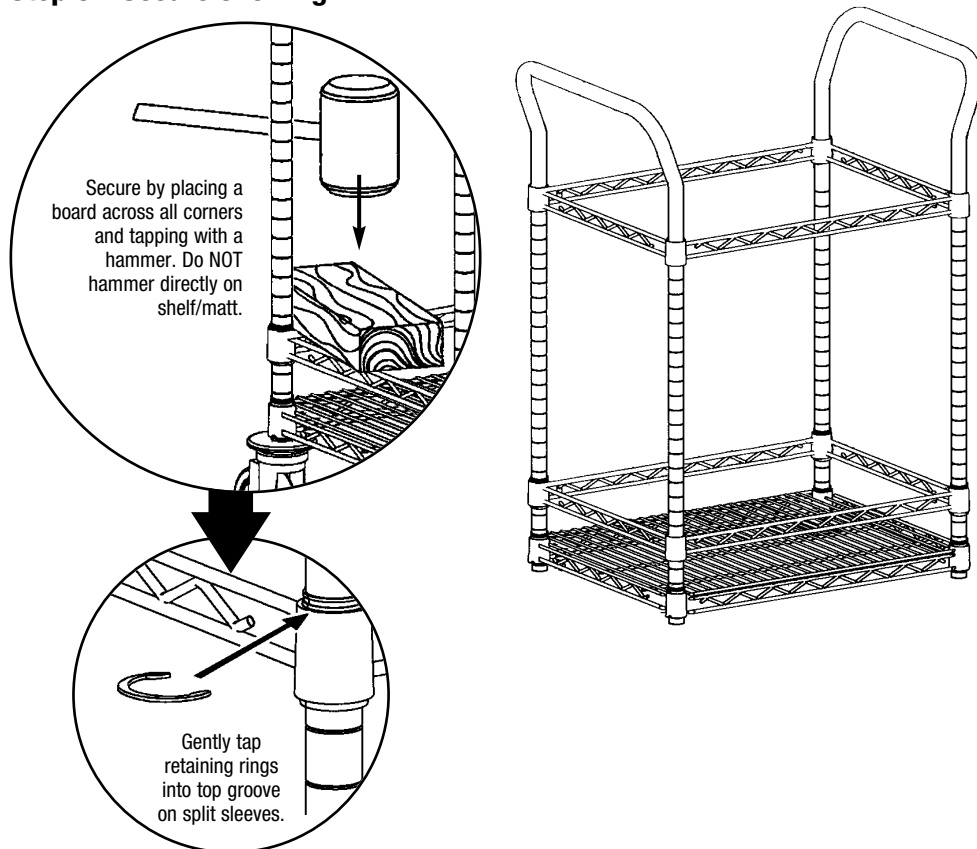

(continued on back page)

# Inhalation Therapy Cart

## ASSEMBLY INSTRUCTIONS

### Step 6 - Secure casters to unit.

- Place donut bumpers onto ends of “U” handles/legs.
- Place caster stems into bottom of “U” handles/legs and drive caster using a hammer or mallet (several solid blows are usually required).

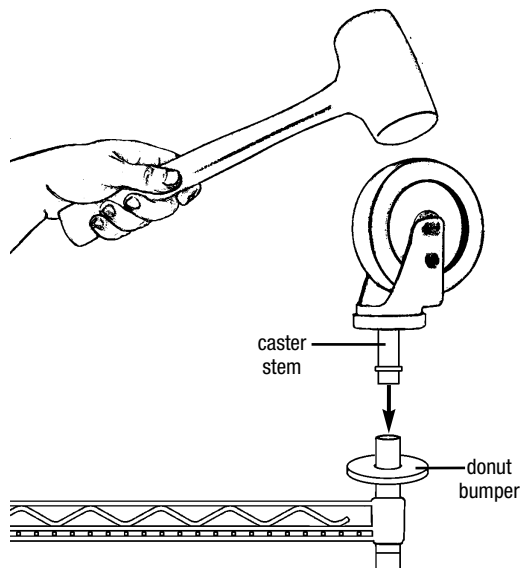

### Step 7 - Snap cylinder rack matt to each truss frame.

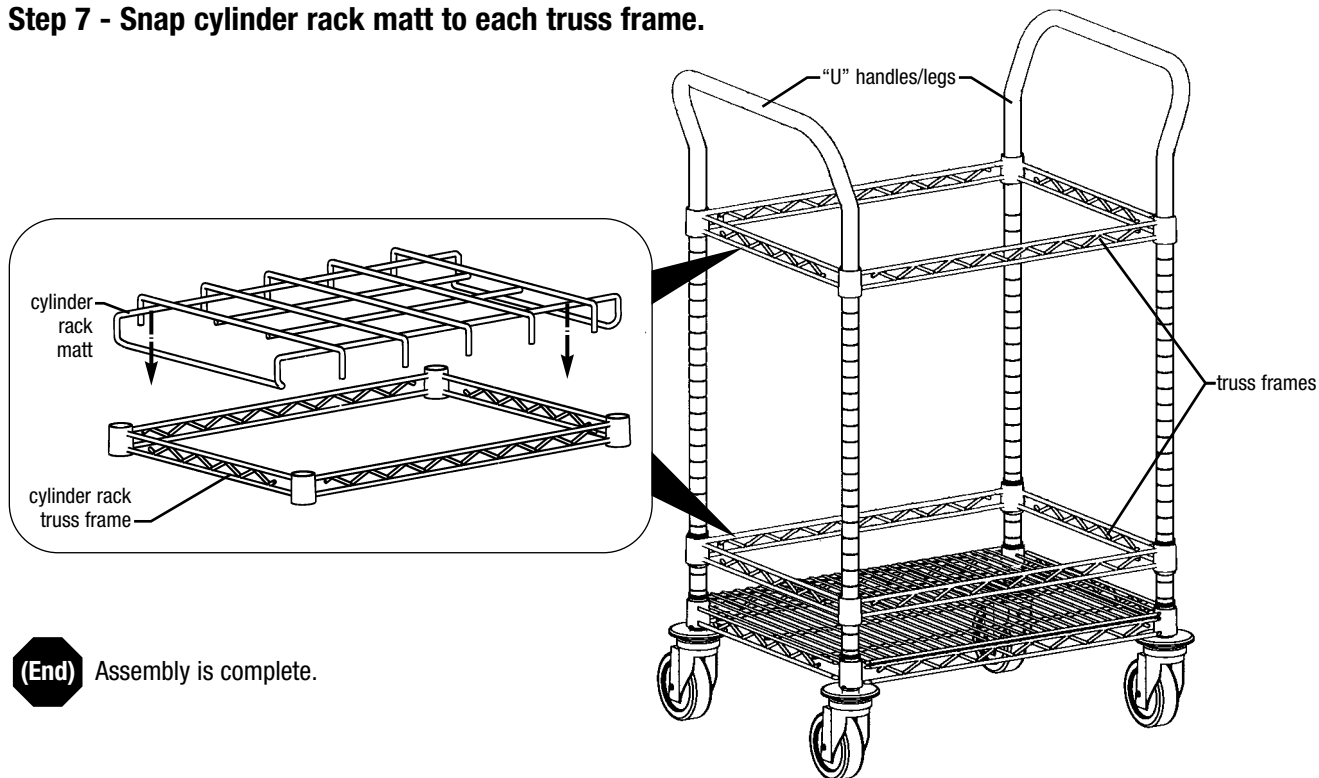

**(End)** Assembly is complete.

**EAGLE**  
GROUP  
Profit from the Eagle Advantage®

• 100 Industrial Boulevard, Clayton, Delaware 19938-8903 U.S.A.  
• Phone: 302/653-3000 • 800/441-8440 • Fax: 302/653-2065  
• [www.eaglegrp.com](http://www.eaglegrp.com) • [www.eaglegrpnews.com](http://www.eaglegrpnews.com) • [www.eaglemhc.com](http://www.eaglemhc.com)

Eagle Foodservice Equipment, Eagle MHC, and SpecFAB® are divisions of Eagle Group. ©2023 by the Eagle Group