

Drawers with NSF Slides

ASSEMBLY INSTRUCTIONS

CAUTION

INSPECT CONTENTS IMMEDIATELY AND FILE CLAIM WITH DELIVERING CARRIER FOR ANY DAMAGE. **SAVE YOUR BOX AND ALL PACKING MATERIALS.** YOU ARE RESPONSIBLE FOR DAMAGE TO YOUR UNIT IF RETURNED IMPROPERLY PACKED.

Parts List

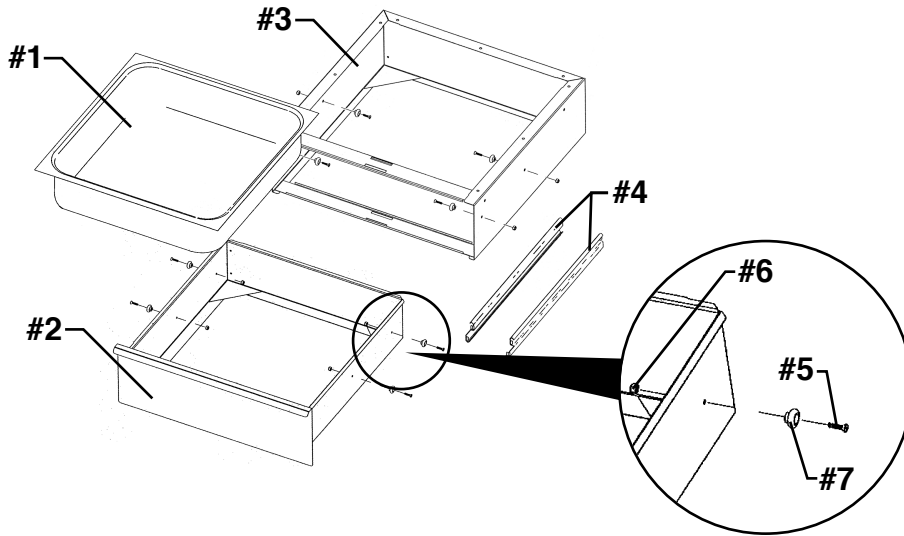

#	qty	description
#1	1	drawer pan
#2	1	drawer frame
#3	1	drawer enclosure
#4	1	pair of slides
#5	8	bolts
#6	8	nuts
#7	8	bearings

Step 1 - Attach bearings to drawer frame.

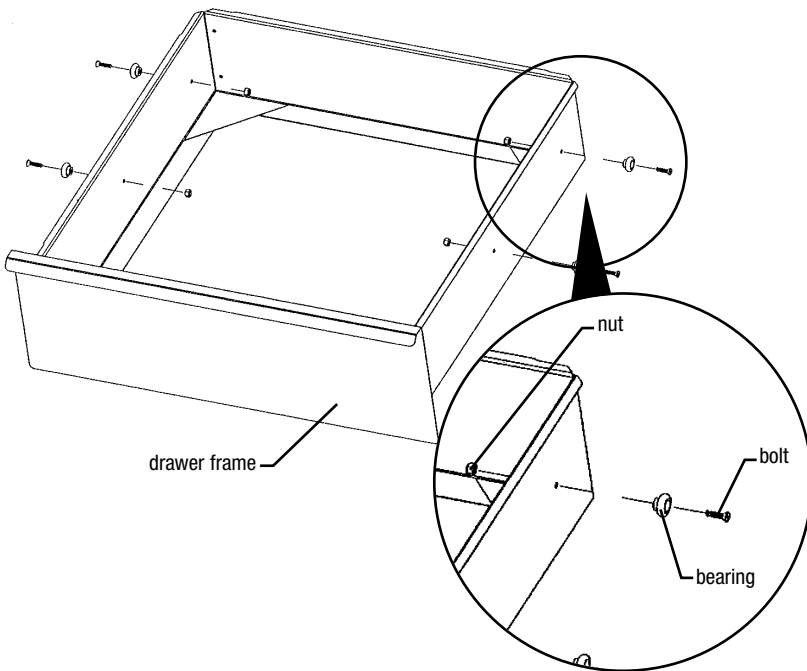

Step 2 - Drop drawer pan into drawer frame.

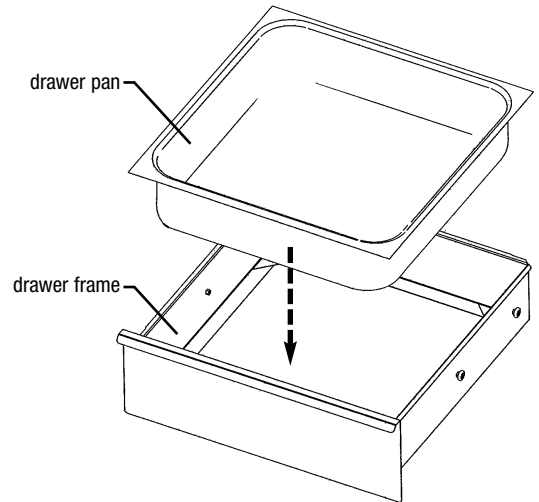

(continued on back page)

Drawers with NSF Slides

ASSEMBLY INSTRUCTIONS

Step 3 - Attach bearings to drawer enclosure.

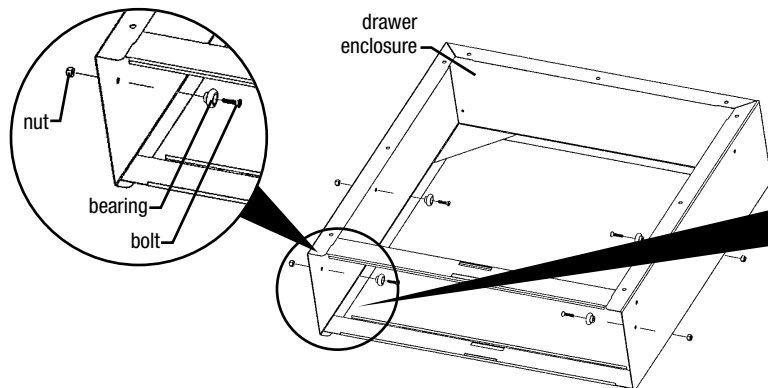

Step 4 - Attach slides to drawer enclosure.

Hang slides on bearings.

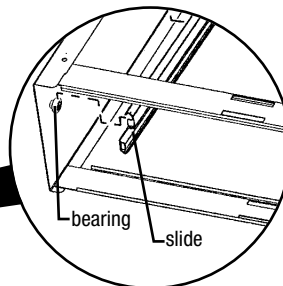

Step 5 - Attach drawer enclosure to hat channels underneath adjoining table.

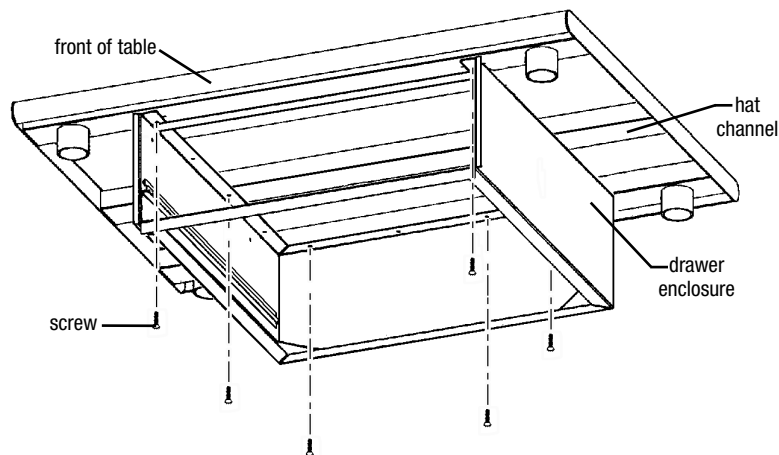

Step 6 - Place drawer pan assembly into drawer enclosure.

- On drawer enclosure, extend slides out as far out as possible.
- Lower rear bearings of drawer pan assembly into slides.
- Slide drawer pan assembly rearward to allow front bearings into slides.

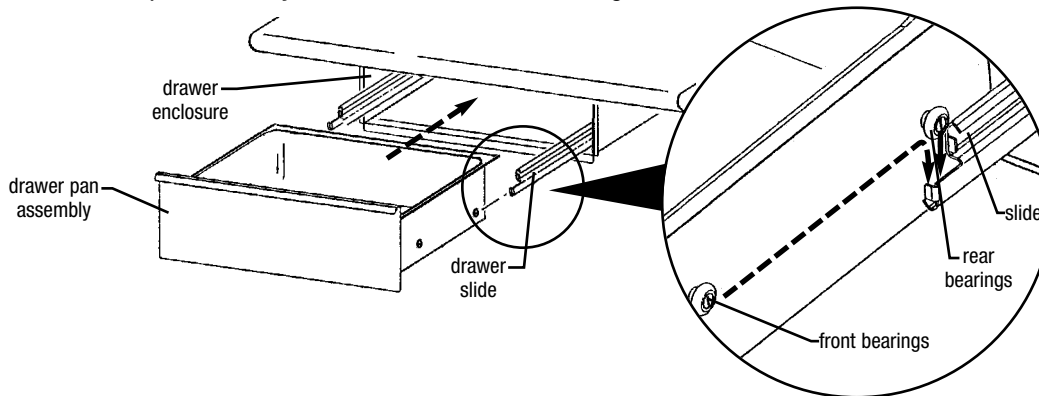

(End)