

Dunnage Rack

ASSEMBLY INSTRUCTIONS

CAUTION

INSPECT CONTENTS IMMEDIATELY AND FILE CLAIM WITH DELIVERING CARRIER FOR ANY DAMAGE. **SAVE YOUR BOX AND ALL PACKING MATERIALS.** YOU ARE RESPONSIBLE FOR DAMAGE TO YOUR UNIT IF RETURNED IMPROPERLY PACKED.

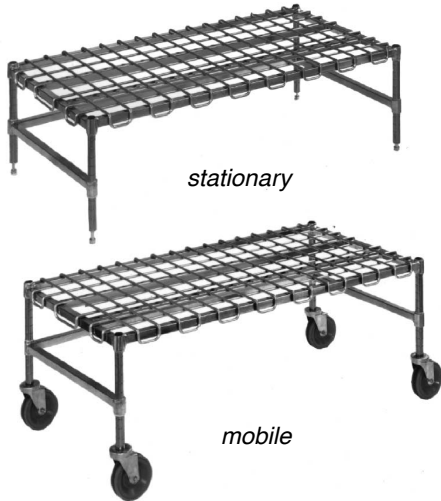

Parts List

Stationary Dunnage		
#	description	qty
1	Dunnage matt	1
2	4-sided frame	1
3	3-sided frame	1
4	Bags of four pairs of split sleeves	2
5	Posts	4

Mobile Dunnage		
#	description	qty
1	Dunnage matt	1
2	4-sided frame	1
3	3-sided frame	1
4	Bags of four pairs of split sleeves	2
5	Posts	4
6	Donut bumpers	4
7	Casters*	4

* 2 swivel casters, 2 with brake

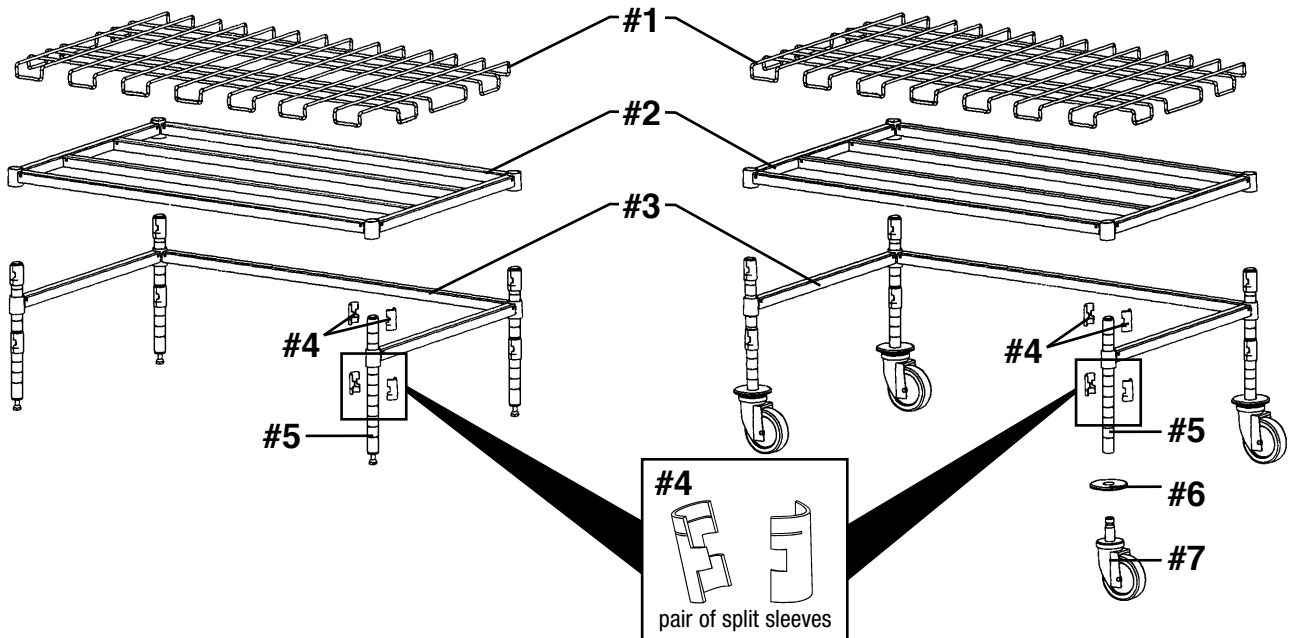

PLEASE READ BEFORE ASSEMBLING DUNNAGE RACK...

- Remove all components from packaging. Using the Parts List (above), check and identify all components.
- Split sleeves must be used in conjunction with the three-sided and four-sided frames. When installing split sleeves, make sure the thicker part of the taper goes toward the bottom. Also make sure the rib inside the split sleeves is seated into the groove on the post. Posts are grooved in 1" increments.
- When installing frames, make sure the thicker part of the collars goes toward the bottom.

(continued on back page) →

EG9829 Revised 09/23



- 100 Industrial Boulevard, Clayton, Delaware 19938-8903 U.S.A.
- Phone: 302/653-3000 • 800/441-8440
- Fax: 302/653-2065 • www.eaglegrp.com

Dunnage Rack

ASSEMBLY INSTRUCTIONS

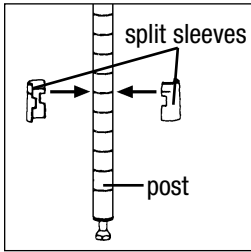

Figure 1a

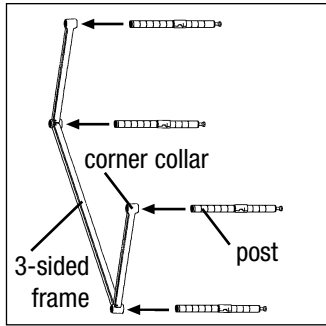

Figure 1b

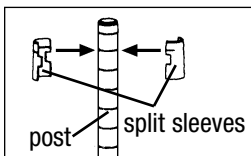

Figure 2a

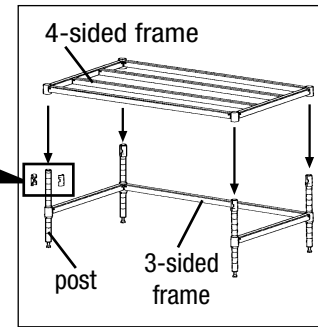

Figure 2b



Figure 3a

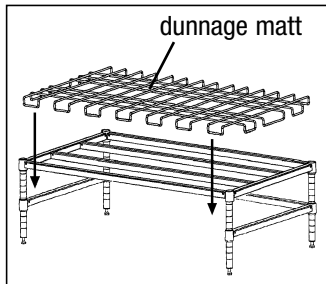

Figure 3b

Stationary Dunnage Racks

1. Assemble 3-sided frame to posts.

A. Snap plastic tapered split sleeves onto each post at the desired position for the 3-sided frame (see *Figure 1a*).

Note: Although the 3-sided frame should be mounted as low as possible for the most stability, NSF requires a minimum of 6" clearance below the frame. For NSF-approved installation, mount frame at the 6th groove or above on each post.

B. Holding the 3-sided frame on its side, insert the posts through the corner collars until the split sleeves are seated snugly within the collars (see *Figure 1b*).

2. Assemble 4-sided frame.

A. Stand the post/frame assembly upright, and snap the split sleeves onto each post at the 1st groove from the top (see *Figure 2a*).

B. Mount the 4-sided frame, inserting the posts through the corner collars until the split sleeves are seated snugly within the collars (see *Figure 2b*).

3. Complete assembly.

A. Securely seat both frames using a board and hammer at each corner (see *Figure 3a*).

B. Place the dunnage mat on the frame (see *Figure 3b*).

(End)

Mobile Dunnage Racks

1. Assemble casters to posts.

A. Place donut bumpers onto bottom end of post. Bottom of post is the end with 1 7/8" ungrooved (see *Figure 1a*).

B. Insert caster stem into bottom of each post. Drive in caster using a hammer or mallet (see *Figure 1b*).

Note: If rigid casters are purchased, place alignment channel (*Figure 1c*) over caster stem before inserting casters.

2. Complete assembly following directions for stationary dunnage racks (above). Always place the 3-sided frame at the lowest position for mobile dunnage racks.

(End)

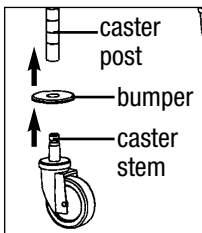

Figure 1a



Figure 1b

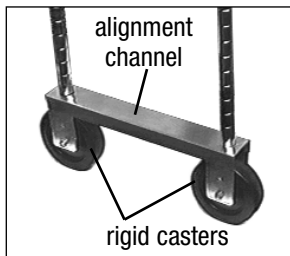

Figure 1c