



Profit from the Eagle Advantage®

Specification Sheet

Short Form Specifications

Available in 24" x 48" and 24" x 60", chrome plated finish. Eight dividers and 12 bin markers standard with 48" units, and 12 dividers and 16 bin markers on 60" units. Standard units feature 5" x 1 1/4" swivel stem casters, two with brake. Heavy duty units feature aluminum dolly base with 6" x 2" swivel plate casters with polyurethane wheels, two with brake. All models include a 24" coat hanger tube and 12 rod and tabs.



#PCH2460C heavy duty cart

Options / Accessories

- Cart covers
- Dividers
- Rods & tabs
- Plastic shelf markers
- 24" x 24" (610 x 610mm) wire shelves
- 24" x 36" (610 x 914mm) wire shelves

EAGLE GROUP

100 Industrial Boulevard, Clayton, DE 19938-8903 USA
 Phone: 302-653-3000 • 800-441-8440 • Fax: 302-653-2065
www.eaglegrp.com
www.eaglegrpnews.com
www.eaglemhc.com

For custom configuration or fabrication needs, contact our **SpecFAB® Division**.
 Phone: 302-653-3000 • Fax: 302-653-2065 • e-mail: quotes@eaglegrp.com

Item No.:	_____
Project No.:	_____
S.I.S. No.:	_____

Patient Article Carts

MODELS:

- PG2448-C**
- PG2460-C**
- PCH2448-C**
- PCH2460-C**

Design and Construction Features

- Top and bottom full-length wire shelves with patented QuadTruss® design (patent #5,390,803).
- Standard units feature 5" (127mm)-diameter polyurethane-tread swivel stem casters, two with brake.
- Heavy duty units feature aluminum dolly frame with 6" (152mm)-diameter polyurethane-tread swivel plate casters, two with brake.
- Chrome finished components.
- 12 rods 63" (1600mm) tall, each with four tabs.
- 24" (610mm)-long coat hanger tube.
- 5" (127mm)-diameter swivel stem casters—two with brake.
- Dividers and bin markers included.





Profit from the Eagle Advantage®

Item No.: _____
 Project No.: _____
 S.I.S. No.: _____

Patient Article Carts

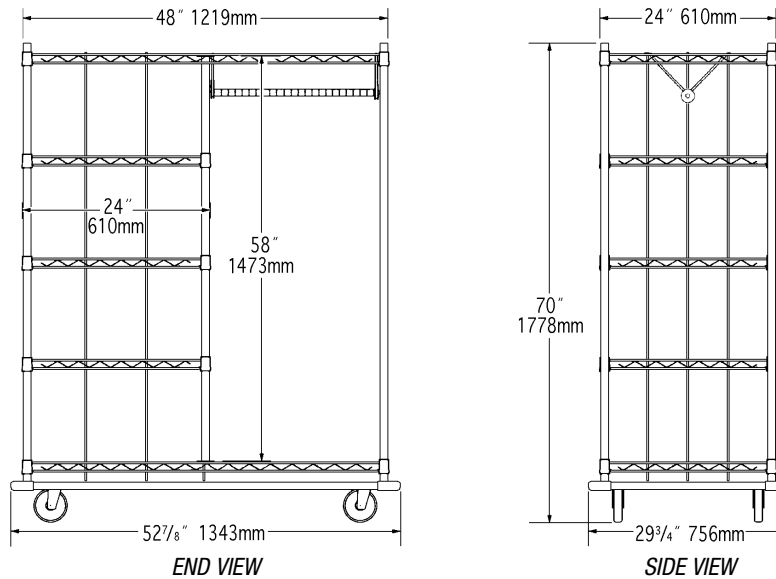

Model #PCH2448-C shown (for clarity, not shown with dividers)

model #	shelf width		shelf length		intermediate shelf length		weight		quantity of dividers	quantity of bin markers	quantity of rods	description
	in.	mm	in.	mm	in.	mm	lbs.	kg				
PC2448-C	24"	610	48"	1219	24"	610	103	46.7	8	12	12	standard
PC2460-C	24"	610	60"	1524	36"	914	126	57.2	12	16	12	standard
PCH2448-C	24"	610	48"	1219	24"	610	166	75.8	8	12	12	heavy duty
PCH2460-C	24"	610	60"	1524	36"	914	188	85.3	12	16	12	heavy duty

OPTIONAL CART COVERS

White Coated Nylon with zipper		White Uncoated Polyester with zipper		shelf width		shelf length		post height		weight	
model #	model #	in.	mm	in.	mm	in.	mm	in.	mm	lbs.	kg
CZC-63-2448	CZ-63-2448	24"	610	48"	1219	63"	1600	4	1.8		
CZC-63-2460	CZ-63-2460	24"	610	60"	1524	63"	1600	5	2.3		

ACCESSORIES

model #	description	weight	
		lbs.	kg
SD24-C	8" (203mm)-tall divider	1.8	0.8
R63-C	rod, with 4 fastening tabs	0.5	0.2
A204331	plastic shelf marker	—	—
2424C	24" x 24" (610 x 610mm) chrome wire shelf	9.5	4.3
2436C	24" x 36" (610 x 914mm) chrome wire shelf	13.6	6.2

EAGLE GROUP

100 Industrial Boulevard, Clayton, DE 19938-8903 USA

Phone: 302-653-3000 or 800-441-8440 • Fax: 302-653-2065

www.eaglegrp.com • www.eaglegrpnews.com • www.eaglehmc.com

Printed in U.S.A.
 ©2023 by Eagle Group

Rev. 06/23

Spec sheets available for viewing, printing or downloading from our online literature library at our websites

Although every attempt has been made to ensure the accuracy of the information provided, we cannot be held responsible for typographical or printing errors. Information and specifications are subject to change without notice. Please confirm at time of order.