



Profit from the Eagle Advantage®

# Specification Sheet

## Short Form Specifications

Eagle Modular Desk/Workstation, model \_\_\_\_\_. Work surface to be 16 gauge type 304 stainless steel. Base secured with 3-sided heavy gauge channel frame with chrome finish. Cantilever chrome finished wire shelves with patented QuadTruss® design (patent # 5,390, 803) and chrome finished rear wall mat. Chrome plated 16 gauge tubular legs with leveling feet.



## Options / Accessories

- Book holder—#BH-1
- Grid shelf—#GS17
- Hanging file folder—#HFH
- Light duty utility shelf—#LDUS12
- Small plastic bin—#A203877
- Plastic bin holder—#PBH
- Plastic bin divider—#A204237
- Wire basket—#WB
- Utensil hook—#UH
- Stainless steel drawer—#500772
- Keyboard Stations—see back page

## EAGLE GROUP

100 Industrial Boulevard, Clayton, DE 19938-8903 USA  
 Phone: 302-653-3000 • 800-441-8440 • Fax: 302-653-2065  
[www.eaglegrp.com](http://www.eaglegrp.com)  
[www.eaglegrpnews.com](http://www.eaglegrpnews.com)  
[www.eaglemhc.com](http://www.eaglemhc.com)

For custom configuration or fabrication needs, contact our **SpecFAB® Division**.  
 Phone: 302-653-3000 • Fax: 302-653-2065 • e-mail: [quotes@eaglegrp.com](mailto:quotes@eaglegrp.com)

Item No.:	_____
Project No.:	_____
S.I.S. No.:	_____

# Modular Desks/Workstations

## MODELS:

- MD2436
- MD2448

## Work Surface

- Stainless steel work surface for durability and easy maintenance.
- Constructed of 16 gauge type 304 stainless steel for strength and durability.

## Cantilever Shelves

- Open wire cantilever shelves reduce dust build-up.
- Cantilever open wire shelves finished in high-luster mirror chrome provide ample storage space for placement of supplies for day-to-day activities.

## Rear Wall Mat

- Constructed of 1/4" (6mm)-diameter mild steel wire with a high luster mirror chrome finish.
- 3' x 3' (76mm x 76mm) grid provides a means for mounting additional accessories.

## Base

- Posts have a high-luster mirror chrome plating over a 1" (25mm)-diameter 16 gauge steel tubular wall, which ensures structural strength and stability in any use.
- Posts are provided with leveling feet to maintain proper balance.
- Heavy gauge three-sided channel frame, finished in high-luster mirror chrome, further stabilizes entire assembly. Channel frame is 1" (25mm) square tubular, mounted approximately 7" (178mm) above the floor.



EG01.02 Rev. 05/23

Spec sheets available for viewing, printing or downloading from our online literature library at our websites

Eagle Foodservice Equipment, Eagle MHC, and SpecFAB® are divisions of Eagle Group. ©2023 by the Eagle Group



Profit from the Eagle Advantage®

Item No.: \_\_\_\_\_  
 Project No.: \_\_\_\_\_  
 S.I.S. No.: \_\_\_\_\_

## Modular Desks/Workstations

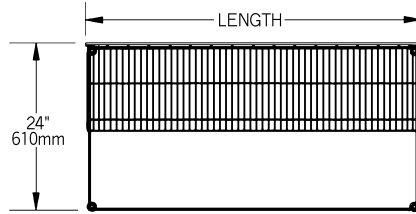

TOP VIEW

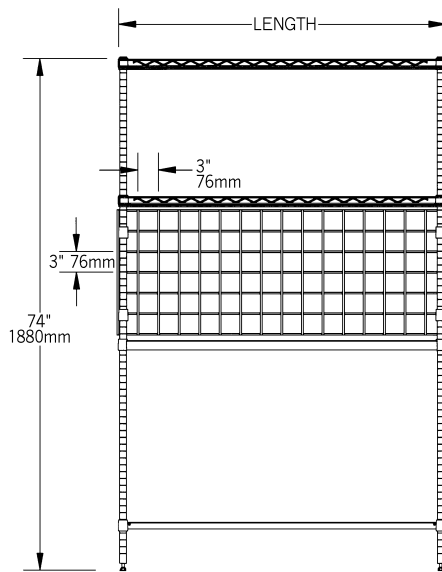

FRONT VIEW

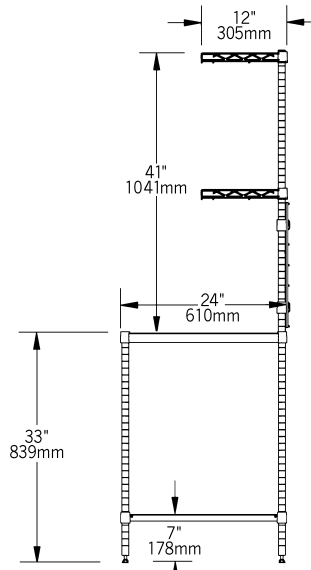

SIDE VIEW

model #	width		length		weight	
	in.	mm	in.	mm	lbs.	kg
<b>MD2436</b>	24"	610	36"	914	78	35.3
<b>MD2448</b>	24"	610	48"	1219	85	38.6

To order with stainless steel keyboard drawer, add suffix "-K". Example: MD2448-K

### Accessories

model #	description	model #	description
<b>BH-1</b>	Book holder	<b>PBH</b>	Plastic bin holder
<b>GS17</b>	Grid shelf	<b>A204237</b>	Plastic bin dividers
<b>HFH</b>	Hanging file holder	<b>WB</b>	Wire basket
<b>LDUS12</b>	Light duty utility shelf	<b>UH</b>	Utensil hook
<b>A203877</b>	Small plastic bin	<b>500772</b>	Stainless steel drawer

### Optional Keyboard Stations

- Mounts under tabletop.
- 20½"-wide x 11½"-deep (521 x 292mm).

model #	description	weight	
		lbs.	kg
<b>KBD-1</b>	chrome	6	2.7
<b>KBD-1/SS</b>	stainless steel	6	2.7

### EAGLE GROUP

100 Industrial Boulevard, Clayton, DE 19938-8903 USA

Phone: 302-653-3000 or 800-441-8440 • Fax: 302-653-2065

www.eaglegrp.com • www.eaglegrpnews.com • www.eaglehmc.com

Printed in U.S.A.  
 ©2023 by Eagle Group

Rev. 05/23

Spec sheets available for viewing, printing or downloading from our online literature library at our websites

Although every attempt has been made to ensure the accuracy of the information provided, we cannot be held responsible for typographical or printing errors. Information and specifications are subject to change without notice. Please confirm at time of order.