



Profit from the Eagle Advantage®

# Specification Sheet

## Short Form Specifications

Eagle Corner Wall Cabinet, model \_\_\_\_\_.  
All stainless steel type 304 cabinet. 13" or 16"-deep. Available as open cabinet or with left or right hinged door. Units are 31"-high and allow cabinetry to transition a 90° inside corner. Removable bottom panel. Two adjustable shelves. Designed and tested to the SEFA 8 Metal Casework recommended practices.

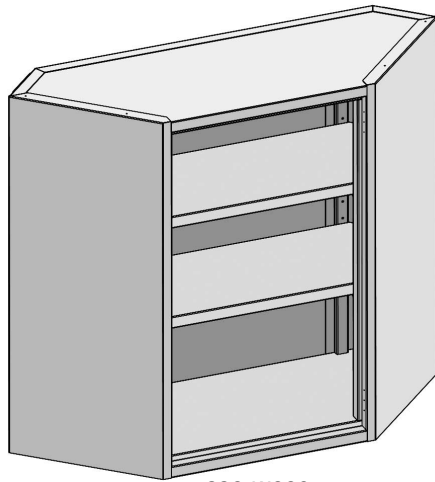

#SSC-WCCO-1318

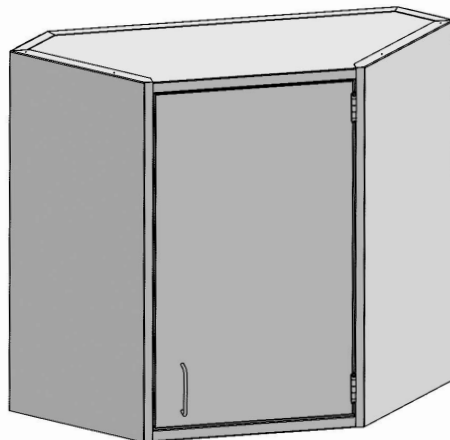

#SSC-WCCHR-1318

Item No.:	_____
Project No.:	_____
S.I.S. No.:	_____

## Upper Cabinets—Corner

### MODELS:

- SSC-WCCO-1318
- SSC-WCCO-1618
- SSC-WCCHL-1318
- SSC-WCCHL-1618
- SSC-WCCHR-1318
- SSC-WCCHR-1618

### Design and Construction Features

- Type 304 stainless steel construction.
- Two intermediate shelves, adjustable on 1-1/2" (38mm) increments.
- Available in 13" or 16" (330mm or 406mm) depth.
- Flat top units are 31" (889mm) high.
- For 90° inside corner transition.

### Options / Accessories

- Door locks
- Additional shelves
- Sloped top cover
- Custom sizes

### EAGLE GROUP

100 Industrial Boulevard  
Clayton, DE 19938-8903 USA

Phone: 302-653-3000 • 800-441-8440

Fax: 302-653-2065

www.eaglegrp.com • www.eaglemhc.com

For custom configuration or fabrication needs, contact our SpecFAB® Division.

Phone: 302-653-3000 • Fax: 302-653-2065 • e-mail: quotes@eaglegrp.com

### Certifications / Approvals



SEFA 8 Metal Casework

Item No.: \_\_\_\_\_  
Project No.: \_\_\_\_\_  
S.I.S. No.: \_\_\_\_\_

### Upper Cabinets—Corner

**13" Cabinet Dimensions**

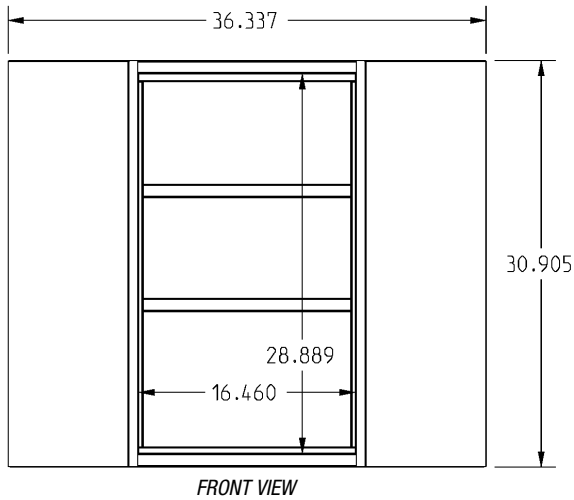
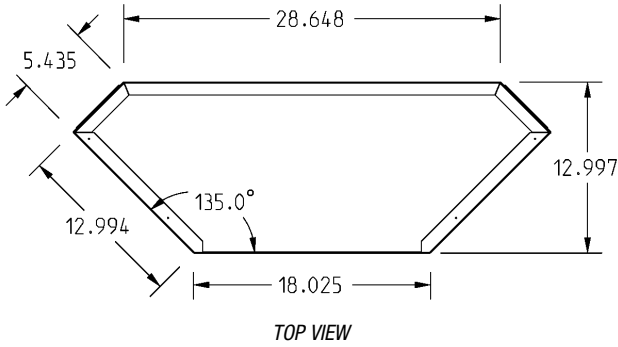

(MODEL #SSC-WCCO-1318 SHOWN)

**16" Cabinet Dimensions**

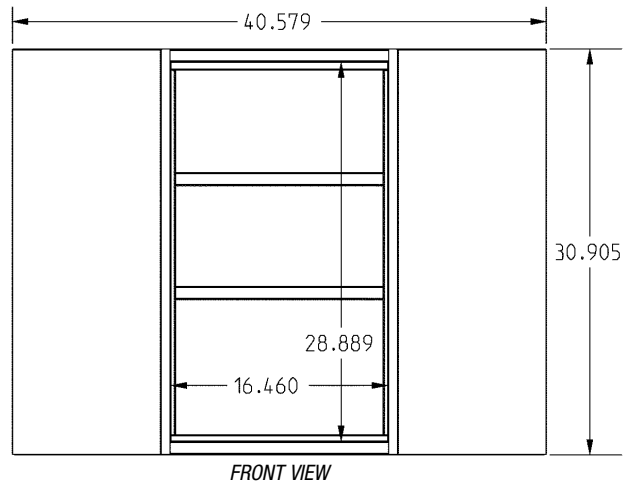
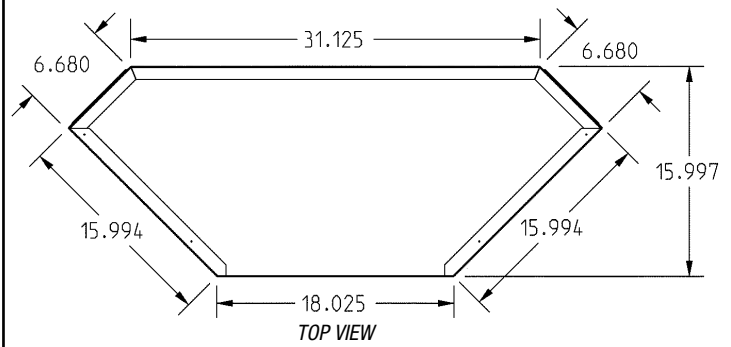

(MODEL #SSC-WCCO-1618 SHOWN)

description	13" front-to-back		16" front-to-back	
	weight lbs.	kg	weight lbs.	kg
open front	120	54.4	135	61.2
with full-height left door	126	57.2	141	64.0
with full-height right door	126	57.2	141	64.0

**EAGLE GROUP**  
100 Industrial Boulevard, Clayton, DE 19938-8903 USA  
Phone: 302-653-3000 or 800-441-8440 • Fax: 302-653-2065  
www.eaglegrp.com • www.eaglehmc.com

Printed in U.S.A.  
©2021 by Eagle Group  
Rev. 10/21

Spec sheets available for viewing, printing or downloading from our online literature library at [www.eaglegrp.com](http://www.eaglegrp.com)

Although every attempt has been made to ensure the accuracy of the information provided, we cannot be held responsible for typographical or printing errors. Information and specifications are subject to change without notice. Please confirm at time of order.