



Profit from the Eagle Advantage®

Specification Sheet

Short Form Specifications

Eagle Single-Deep Floor-Trak® High Density Storage System for Wire Shelving, with non-corrosive aluminum tracks with end stops. Skate Kits are aircraft quality aluminum with stainless steel inserts and hardened steel bearings, one kit required for each mobile unit. System is ADA compliant. Note: Floor-Trak® Kits, Skate Kits, Posts, and Wire Shelving all need to be ordered separately.

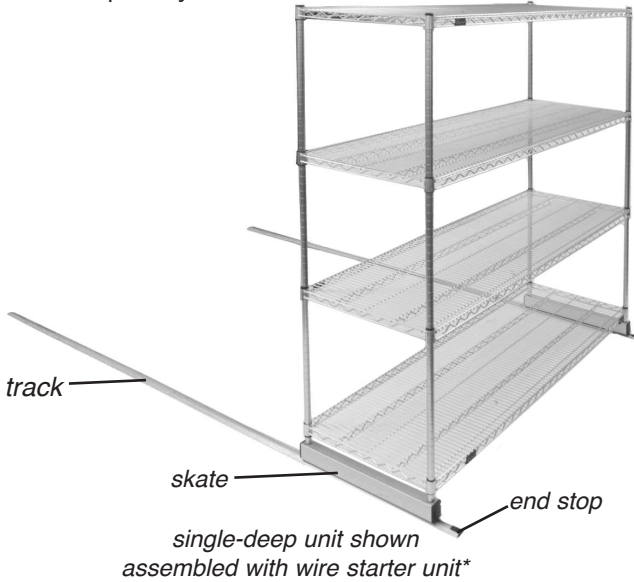

*Wire shelving sold separately.

Options / Accessories

- Bumper Brackets
- Shim Kit (#912991)
- Foot Brake Kit (#MFBK-S)

Bumper Brackets available:

- Helps prevent shelf unit from tipping over due to uneven floor or due to unevenly distributed weight of shelf contents.
- Once installed, brackets hover over track of Floor-Trak® system, but do not make contact with track unless shelf unit begins to tip over.
- Easily attaches to skate kit of any Floor-Trak® system, along with post of adjoining shelf unit.
- All-welded stainless steel construction, with heavy duty ¼" (6mm)-diameter rod.

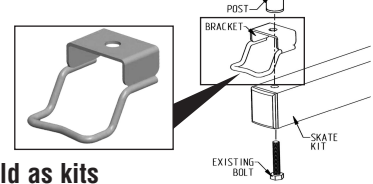

...sold as kits

for use with	# of brackets included	model #
single-deep skate kits	4	SDSKATB-S

...sold individually (hardware included)

model # SKATB-S

Item No.: _____
 Project No.: _____
 S.I.S. No.: _____

Single-Deep Floor-Trak® Systems —for use with Wire Shelving

MODELS:

- SDFT-*
- SDSK-*

* See charts for complete model numbers.

- Floor-Trak® system designed for use with wire shelving units.
- Consolidates space.
- Low profile, non-corrosive track constructed of stainless steel and anodized aluminum.
- The system is ADA-compliant.
- Simple and easy to install.
- Easy to add on additional units.
- Open construction allows for the use of cart covers when required.
- Industrial-type, hardened steel bearings allow loaded units to glide effortlessly over the track.

Wire Shelving (sold separately)

- Patented QuadTruss® design makes shelves up to 25% stronger.
- Open-wire construction promotes higher visibility and reduces dust build-up.
- Posts are numbered in 1" (25mm) increments for fast and level assembly.
- Many finishes available—from zinc to stainless steel.

EAGLE GROUP
 100 Industrial Boulevard, Clayton, DE 19938-8903 USA
 Phone: 302-653-3000 • Fax: 302-653-2065
 www.eaglegrp.com

Foodservice Division: Phone 800-441-8440
MHC/Retail Display Divisions: Phone 800-637-5100

For custom configuration or fabrication needs, contact our **SpecFAB® Division**.
 Phone: 302-653-3000 • Fax: 302-653-3091 • e-mail: specfab@eaglegrp.com

Certifications / Approvals



AUTOQUOTES



EG01.39A Rev. 04/12

Spec sheets available for viewing, printing or downloading from our online literature library at www.eaglegrp.com

Eagle Foodservice Equipment, Eagle MHC, SpecFAB®, and Retail Display are divisions of Eagle Group. ©2012 by the Eagle Group



Profit from the Eagle Advantage®

Item No.: _____
 Project No.: _____
 S.I.S. No.: _____

Single-Deep Floor-Trak® Systems—for use with Wire Shelving

Floor Track Kits

Each kit consists of a pair of aluminum tracks with end stops. All hardware and assembly instructions included.

Note: Not recommended to piece tracks together. Order length needed. Custom lengths available. Consult factory.

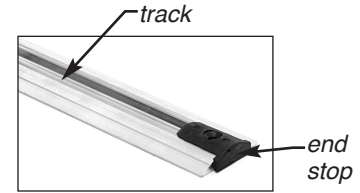

model #	length		weight	
	ft.	mm	lbs.	kg
SDFT-6	6'	1829	5	2.3
SDFT-7	7'	2134	5	2.3
SDFT-8	8'	2438	6	2.7
SDFT-9	9'	2743	7	3.2
SDFT-10	10'	3048	8	3.6
SDFT-11	11'	3353	8	3.6
SDFT-12	12'	3658	9	4.1
SDFT-13	13'	3962	10	4.5
SDFT-14	14'	4267	11	5.0
SDFT-15	15'	4572	11	5.0
SDFT-16	16'	4877	12	5.4
SDFT-17	17'	5181	13	5.8
SDFT-18	18'	5486	14	6.4

model #	length		weight	
	ft.	mm	lbs.	kg
SDFT-19	19'	5791	14	6.4
SDFT-20	20'	6096	15	6.8
SDFT-21	21'	6401	16	7.3
SDFT-22	22'	6706	17	7.7
SDFT-23	23'	7010	18	8.2
SDFT-24	24'	7315	19	8.6
SDFT-25	25'	7620	20	9.0
SDFT-26	26'	7925	21	9.5
SDFT-27	27'	8230	22	10.0
SDFT-28	28'	8534	23	10.4
SDFT-29	29'	8839	24	10.9
SDFT-30	30'	9144	25	11.3

Skate Kits

Kit includes two aluminum skates and all necessary parts and hardware. Skates are aircraft-quality aluminum with stainless steel inserts and hardened steel ball bearings. One kit is required for each mobile unit. Shelves and posts not included. Weight capacity of 2000 lbs. (907.2 kg) per mobile section.

Note: When assembling with shelf unit, add 1" (25mm) to width and length of shelf unit.



skate kit for single-deep systems

model #	width		weight	
	in.	mm	lbs.	kg
SDSK-18	18"	457	6	2.7
SDSK-21	21"	533	7	3.2
SDSK-24	24"	610	7	3.2
SDSK-30	30"	762	8	3.6
SDSK-36	36"	914	10	4.5

EAGLE GROUP

100 Industrial Boulevard, Clayton, DE 19938-8903 USA

Phone: 302-653-3000 • Fax: 302-653-2065

www.eaglegrp.com

Foodservice Division: Phone 800-441-8440

MHC/Retail Display Divisions: Phone 800-637-5100

Printed in U.S.A.
 ©2012 by Eagle Group

Rev. 04/12

Spec sheets available for viewing, printing or downloading from our online literature library at www.eaglegrp.com

Although every attempt has been made to ensure the accuracy of the information provided, we cannot be held responsible for typographical or printing errors. Information and specifications are subject to change without notice. Please confirm at time of order.



Profit from the Eagle Advantage®

Specification Sheet

Short Form Specifications

Eagle Double-Deep Floor-Trak® High Density Storage System for Wire Shelving, with non-corrosive aluminum tracks with end stops. Skate Kits are aircraft quality aluminum with stainless steel inserts and hardened steel bearings, one kit required for each mobile unit. System is ADA compliant. Note: Floor-Trak® Kits, Skate Kits, Posts, and Wire Shelving all need to be ordered separately.

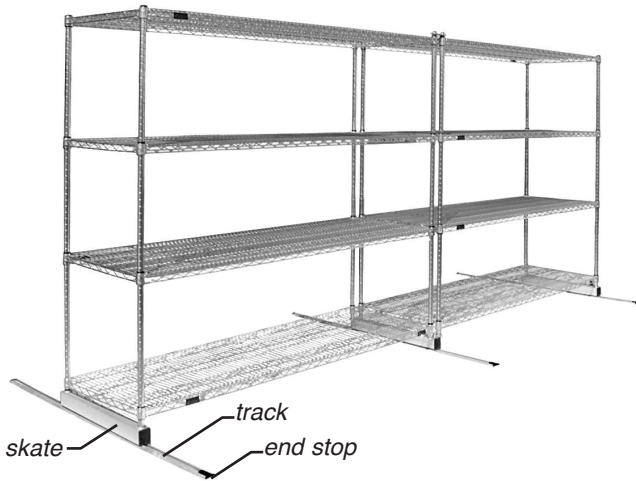

double-deep unit shown assembled with two wire starter units*

*Wire shelving sold separately.

Options / Accessories

- Bumper brackets
- Shim Kit (#912991)
- Foot Brake Kit (#MFBK-S)

Bumper Brackets available:

- Helps prevent shelf unit from tipping over due to uneven floor or due to unevenly distributed weight of shelf contents.
- Once installed, brackets hover over track of Floor-Trak® system, but do not make contact with track unless shelf unit begins to tip over.
- Easily attaches to skate kit of any Floor-Trak® system, along with post of adjoining shelf unit.
- All-welded stainless steel construction, with heavy duty 1/4" (6mm)-diameter rod.

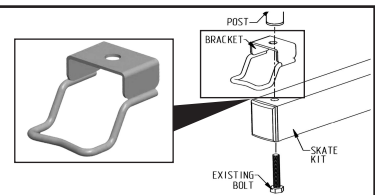

...sold as kits

for use with	# of brackets included	model #
double-deep skate kits	6	DDSKATB-S

...sold individually (hardware included)

model # SKATB-S

EAGLE GROUP
 100 Industrial Boulevard, Clayton, DE 19938-8903 USA
 Phone: 302-653-3000 • Fax: 302-653-2065
 www.eaglegrp.com

Foodservice Division: Phone 800-441-8440
MHC/Retail Display Divisions: Phone 800-637-5100

For custom configuration or fabrication needs, contact our **SpecFAB® Division**.
 Phone: 302-653-3000 • Fax: 302-653-2065 • e-mail: quotes@eaglegrp.com

Certifications / Approvals



AUTOQUOTES



EG01.39B Rev. 02/15

Spec sheets available for viewing, printing or downloading from our online literature library at www.eaglegrp.com

Eagle Foodservice Equipment, Eagle MHC, SpecFAB®, and Retail Display are divisions of Eagle Group. ©2015 by the Eagle Group

Item No.: _____
 Project No.: _____
 S.I.S. No.: _____

Double-Deep Floor-Trak® Systems —for use with Wire Shelving

MODELS:

- DDFT-* TEP74-*
- DDSK-* TEP86-*

* See charts for complete model numbers.

- Floor-Trak® system designed for use with wire shelving units.
- Consolidates space.
- Low profile, non-corrosive track constructed of stainless steel and anodized aluminum.
- The system is ADA-compliant.
- Simple and easy to install.
- Can be built double-deep and not impede rollability.
- Easy to add on additional units.
- Open construction allows for the use of cart covers when required.
- Industrial-type, hardened steel bearings allow loaded units to glide effortlessly over the track.

Wire Shelving (sold separately)

- Patented QuadTruss® design makes shelves up to 25% stronger.
- Open-wire construction promotes higher visibility and reduces dust build-up.
- Posts are numbered in 1" (25mm) increments for fast and level assembly.
- Many finishes available—from zinc to stainless steel.



Profit from the Eagle Advantage®

Item No.: _____
 Project No.: _____
 S.I.S. No.: _____

Double-Deep Floor-Trak® Systems—for use with Wire Shelving

Floor Track Kits

Each kit consists of three aluminum tracks with end stops. All hardware and assembly instructions included.

Note: Not recommended to piece tracks together. Order length needed. Custom lengths available. Consult factory.

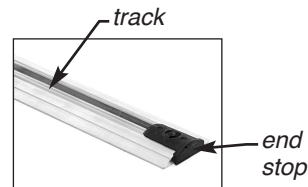

model #	length		weight	
	ft.	mm	lbs.	kg
DDFT-6	6'	1829	7	3.2
DDFT-7	7'	2134	8	3.6
DDFT-8	8'	2438	9	4.1
DDFT-9	9'	2743	10	4.5
DDFT-10	10'	3048	13	5.8
DDFT-11	11'	3353	14	6.4
DDFT-12	12'	3658	15	6.8
DDFT-13	13'	3962	16	7.3
DDFT-14	14'	4267	16	7.3
DDFT-15	15'	4572	17	7.7
DDFT-16	16'	4877	18	8.2
DDFT-17	17'	5181	19	8.6
DDFT-18	18'	5486	21	9.5

model #	length		weight	
	ft.	mm	lbs.	kg
DDFT-19	19'	5791	22	10.0
DDFT-20	20'	6096	23	10.4
DDFT-21	21'	6401	24	10.9
DDFT-22	22'	6706	25	11.3
DDFT-23	23'	7010	26	11.8
DDFT-24	24'	7315	27	12.2
DDFT-25	25'	7620	28	12.7
DDFT-26	26'	7925	29	13.2
DDFT-27	27'	8230	30	13.6
DDFT-28	28'	8534	31	14.1
DDFT-29	29'	8839	32	14.5
DDFT-30	30'	9144	33	15.0

NOTE: Double-deep units should not exceed shelving depths of 12' (3658mm). 11' and 12' (2794 and 3658mm)-deep units should be used only with 24", 30" or 36" (610, 762, or 914mm)-wide shelves.

Skate Kits

Kit includes three aluminum skates and all necessary parts and hardware. Skates are aircraft-quality aluminum with stainless steel inserts and hardened steel ball bearings. One kit is required for each mobile unit. Shelves and posts not included. Weight capacity of 1500 lbs. (680.4 kg) per mobile section—3000 lbs. (1361 kg) at middle skate.

Note: When assembling with shelf unit, add 1" (25mm) to width and 3" (76mm) to length of shelf unit.

model #	width		weight	
	in.	mm	lbs.	kg
DDSK-18	18"	457	10	4.5
DDSK-21	21"	533	11	5.0
DDSK-24	24"	610	12	5.4
DDSK-30	30"	762	14	6.4
DDSK-36	36"	914	16	7.3

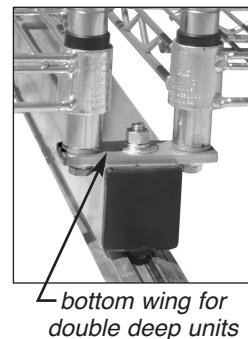

Inside Posts for Double-Deep Units

Each double deep unit requires set of four 'inside posts' (listed below) along with four standard 'stationary posts' (not included).

SET OF FOUR 74" (1880mm) POSTS				SET OF FOUR 86" (2184mm) POSTS			
EAGLEbrite® model #	chrome model #	EAGLEgard® model #	weight lbs. kg	EAGLEbrite® model #	chrome model #	EAGLEgard® model #	weight lbs. kg
TEP74-Z	TEP74-C	TEP74-E	17 7.7	TEP86-Z	TEP86-C	TEP86-E	21 9.5

IMPORTANT – Maximum post height per skate size:

For 18", 21", and 24" wide skates: 74" or less post height; For 30" and 36" wide skates: 86" or less post height.

EAGLE GROUP

100 Industrial Boulevard, Clayton, DE 19938-8903 USA

Phone: 302-653-3000 • Fax: 302-653-2065

www.eaglegrp.com

Foodservice Division: Phone 800-441-8440

MHC/Retail Display Divisions: Phone 800-637-5100

Printed in U.S.A.
 ©2015 by Eagle Group

Rev. 02/15

Spec sheets available for viewing, printing or downloading from our online literature library at www.eaglegrp.com

Although every attempt has been made to ensure the accuracy of the information provided, we cannot be held responsible for typographical or printing errors. Information and specifications are subject to change without notice. Please confirm at time of order.