



Profit from the Eagle Advantage®

Specification Sheet

Item No.:	_____
Project No.:	_____
S.I.S. No.:	_____

Hangers and Hanger Bar Kits

MODELS:

- | | | |
|---------------------------------|-----------------------------------|-----------------------------------|
| <input type="checkbox"/> CLH-C | <input type="checkbox"/> TPH-C | <input type="checkbox"/> HBK-60C |
| <input type="checkbox"/> CLH-S | <input type="checkbox"/> TPH-S | <input type="checkbox"/> HBK-60S |
| <input type="checkbox"/> CLH-EP | <input type="checkbox"/> TPH-EP | <input type="checkbox"/> HBK-60EP |
| <input type="checkbox"/> OLH-C | <input type="checkbox"/> HBK-48C | <input type="checkbox"/> HBK-72C |
| <input type="checkbox"/> OLH-S | <input type="checkbox"/> HBK-48S | <input type="checkbox"/> HBK-72S |
| <input type="checkbox"/> OLH-EP | <input type="checkbox"/> HBK-48EP | <input type="checkbox"/> HBK-72EP |

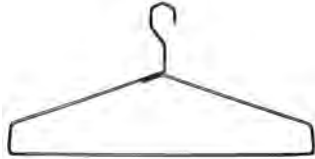

open loop hanger

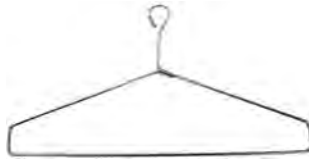

closed loop hanger



two-piece hanger



hanger bar kit

Open and Closed Loop Hangers

- For freestanding or wall mounted gowning racks, removable and non-removable hanger models.
- Accommodates 1" (25mm)-diameter hanger rods.
- Closed loop hangers discourage removal from the gowning area.

Two-Piece Hangers

- For use with non-removable hanger models.
- Top component is affixed to the gowning rack, while the bottom component is removable for convenient mounting of the garment.
- These hangers discourage removal from the gowning area.

Hanger Bar Kits *

- Converts existing wire shelving into freestanding or wall mounted gowning racks.
- End brackets clip onto underside of wire shelf, hanger bar bolts onto end brackets.
- Hanger slots on standard 2½" (64mm) centers. Other spacing available.
- For use with two-piece hangers and open loop hangers only.
- Mounts onto underside of 24" (610mm)-wide wire shelves only.

* Hangers not included with Hanger Bar Kits.

EAGLE GROUP
 100 Industrial Boulevard, Clayton, DE 19938-8903 USA
 Phone: 302-653-3000 • Fax: 302-653-2065
 www.eaglegrp.com

Foodservice Division: Phone 800-441-8440
MHC/Retail Display Divisions: Phone 800-637-5100

For custom configuration or fabrication needs, contact our **SpecFAB® Division**.
 Phone: 302-653-3000 • Fax: 302-653-3091 • e-mail: specfab@eaglegrp.com

EG04.06 Rev. 05/10

Spec sheets available for viewing, printing or downloading from our online literature library at www.eaglegrp.com



Item No.: _____
 Project No.: _____
 S.I.S. No.: _____

Hangers

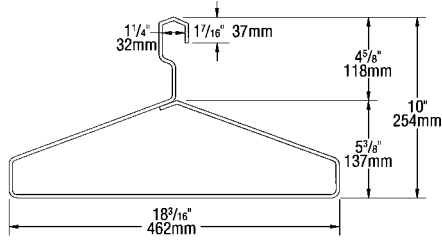

Open Loop Hangers

chrome model #	stainless model #	electropolished model #	weight	
<i>OLH-C</i>	<i>OLH-S</i>	<i>OLH-EP</i>	0.4	0.2

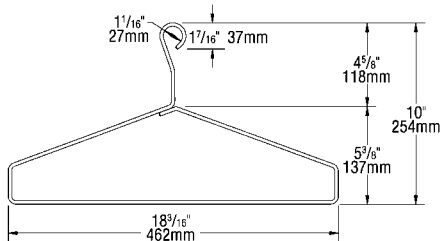

Closed Loop Hangers

chrome model #	stainless model #	electropolished model #	weight	
<i>CLH-C</i>	<i>CLH-S</i>	<i>CLH-EP</i>	0.4	0.2

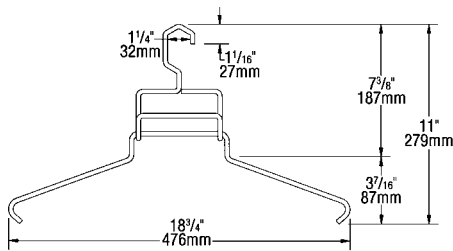

Two-Piece Hangers

chrome model #	stainless model #	electropolished model #	weight	
<i>TPH-C</i>	<i>TPH-S</i>	<i>TPH-EP</i>	0.5	0.2

Hanger Bar Kits



chrome model #	stainless model #	electropolished model #	length in.	length mm	weight lbs.	weight kg	# of hanger slots
<i>HBK-48C</i>	<i>HBK-48S</i>	<i>HBK-48EP</i>	48"	1219	7.0	3.2	17
<i>HBK-60C</i>	<i>HBK-60S</i>	<i>HBK-60EP</i>	60"	1524	9.5	4.3	22
<i>HBK-72C</i>	<i>HBK-72S</i>	<i>HBK-72EP</i>	72"	1829	12.0	5.4	27

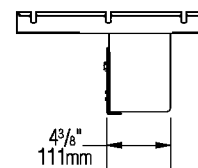
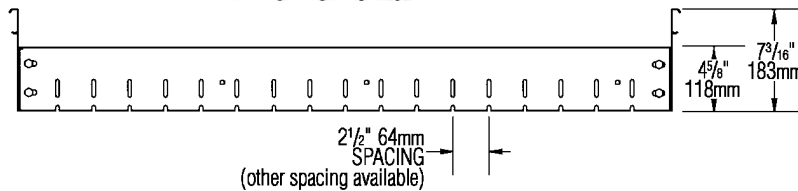

EAGLE GROUP
 100 Industrial Boulevard, Clayton, DE 19938-8903 USA
 Phone: 302-653-3000 • Fax: 302-653-2065
 www.eaglegrp.com

Foodservice Division: Phone 800-441-8440
 MHC/Retail Display Divisions: Phone 800-637-5100

Printed in U.S.A.
 ©2010 by Eagle Group
 Rev. 05/10

Spec sheets available for viewing, printing or downloading from our online literature library at www.eaglegrp.com

Although every attempt has been made to ensure the accuracy of the information provided, we cannot be held responsible for typographical or printing errors. Information and specifications are subject to change without notice. Please confirm at time of order.