



Profit from the Eagle Advantage®

Specification Sheet

Short Form Specifications

All stainless steel type 304 enclosed cabinet. Four adjustable shelves, 18" or 24"-deep by 36"- or 48"-long. Available with sloped top for laminar flow.



#SSC-TSC-1836
stationary unit



#SSC-TSC-2436-CPB
mobile unit

Options / Accessories

- Glass doors (replace "TSC" with "TSCG" in model #*)
- Door locks (add suffix "-L" to model #**)
- Additional shelves
- Custom sizes

* Example: SSC-TSCG-1836

** Example: SSC-TSC-1836-L

EAGLE GROUP

100 Industrial Boulevard, Clayton, DE 19938-8903 USA

Phone: 302-653-3000 • Fax: 302-653-2065

www.eaglegrp.com • www.eaglemhc.com

Foodservice Division: Phone 800-441-8440

MHC Division: Phone 800-637-5100

For custom configuration or fabrication needs, contact our SpecFAB® Division.

Phone: 302-653-3000 • Fax: 302-653-2065 • e-mail: quotes@eaglegrp.com

Item No.:	_____
Project No.:	_____
S.I.S. No.:	_____

Vertical Storage Cabinets

MODELS:

- | | |
|---|---|
| <input type="checkbox"/> SSC-TSC-1836 | <input type="checkbox"/> SSC-TSCST-1836 |
| <input type="checkbox"/> SSC-TSC-1848 | <input type="checkbox"/> SSC-TSCST-1848 |
| <input type="checkbox"/> SSC-TSC-2436-CPB | <input type="checkbox"/> SSC-TSCST-2436-CPB |
| <input type="checkbox"/> SSC-TSC-2436 | <input type="checkbox"/> SSC-TSCST-2436 |
| <input type="checkbox"/> SSC-TSC-2448-CPB | <input type="checkbox"/> SSC-TSCST-2448-CPB |
| <input type="checkbox"/> SSC-TSC-2448 | <input type="checkbox"/> SSC-TSCST-2448 |

Design and Construction Features

- Type 304 stainless steel construction.
- Four adjustable intermediate shelves.
- Stainless steel hinged doors with wire-style pulls.
- Stationary units feature stainless steel legs with 1" (25mm) adjustable bullet feet.
- Mobile "-CPB" units include 5" (127mm)-diameter swivel/brake casters with poly tread.
- Stationary units offered in 18" or 24" (457 or 610mm) front-to-back.
- Mobile units are 24" (457 or 610mm) front-to-back.
- Available in 36" and 48" (914 and 1219mm) lengths.
- Available with flat top or sloped top.
- Custom sizes available.

Spec sheets available for viewing, printing or downloading from our online literature library at www.eaglegrp.com



Profit from the Eagle Advantage®

Item No.: _____
 Project No.: _____
 S.I.S. No.: _____

Vertical Storage Cabinets

Units with Flat Top

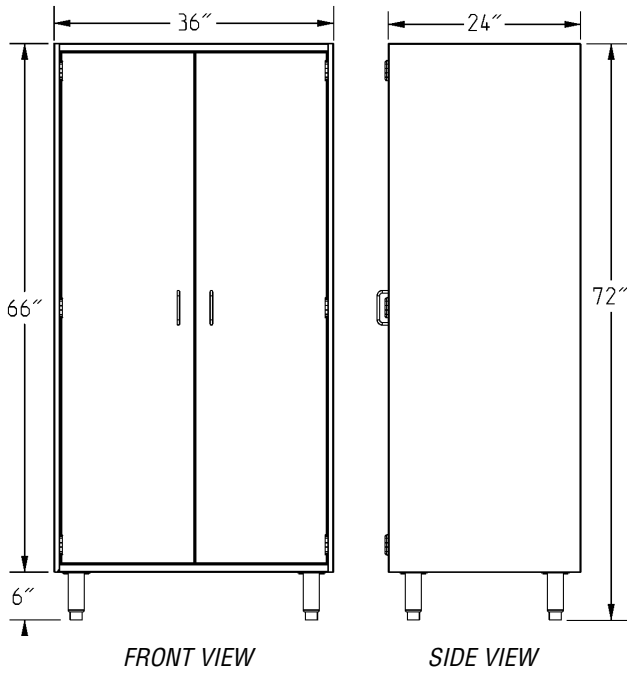

(#SSC-TSC-2436 shown)

Units with Sloped Top

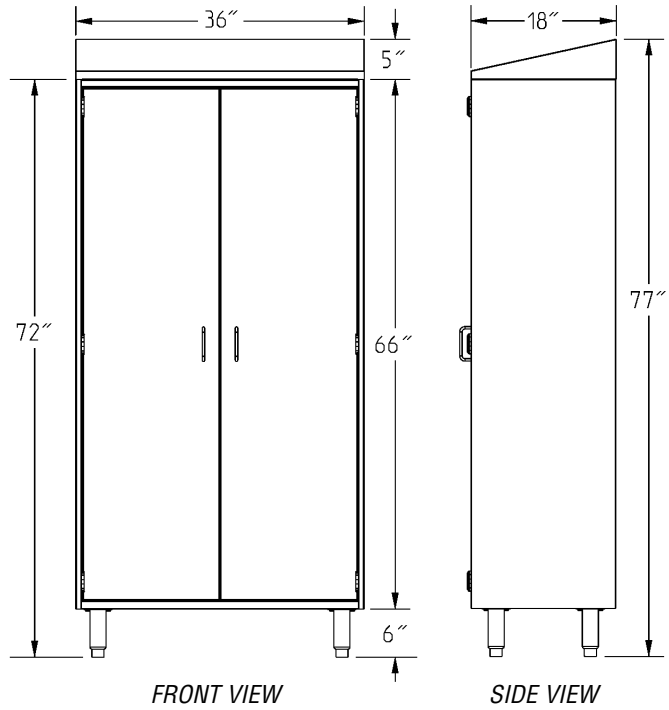

(#SSC-TSCST-1836 shown)

depth		width			height		weight		model #	height		weight		model #
in	mm	in.	mm		in.	mm	lbs.	kg		in.	mm	lbs.	kg	
18"	457	36"	914	stationary	72"	1829	416	188.7	SSC-TSC-1836	77"	1956	419	190.0	SSC-TSCST-1836
18"	457	48"	1219	stationary	72"	1829	490	222.3	SSC-TSC-1848	77"	1956	495	224.5	SSC-TSCST-1848
24"	610	36"	914	stationary	72"	1829	458	207.7	SSC-TSC-2436	77"	1956	461	209.1	SSC-TSCST-2436
24"	610	48"	1219	stationary	72"	1829	539	244.5	SSC-TSC-2448	77"	1956	545	247.2	SSC-TSCST-2448
24"	610	36"	914	mobile	72"	1829	462	209.6	SSC-TSC-2436-CPB	78"	1981	465	210.9	SSC-TSCST-2436-CPB
24"	610	48"	1219	mobile	72"	1829	543	246.3	SSC-TSC-2448-CPB	78"	1981	549	249.0	SSC-TSCST-2448-CPB

EAGLE GROUP
 100 Industrial Boulevard, Clayton, DE 19938-8903 USA
 Phone: 302-653-3000 • Fax: 302-653-2065
 www.eaglegrp.com • www.eaglegrp.com

Foodservice Division: Phone 800-441-8440
 MHC Division: Phone 800-637-5100

Printed in U.S.A.
 ©2020 by Eagle Group
 Rev. 09/20

Spec sheets available for viewing, printing or downloading from our online literature library at www.eaglegrp.com

Although every attempt has been made to ensure the accuracy of the information provided, we cannot be held responsible for typographical or printing errors. Information and specifications are subject to change without notice. Please confirm at time of order.