

Item No.: \_\_\_\_\_  
 Project No.: \_\_\_\_\_  
 S.I.S. No.: \_\_\_\_\_

## Specification Sheet

### Short Form Specifications

All stainless steel type 304 enclosed cabinet. 18" or 24"-deep. Flat top units are 84"-high, sloped top units are 89"-high. Widths range from 24" to 48". Five adjustable shelves. Designed and tested to the SEFA 8 Metal Casework recommended practices.

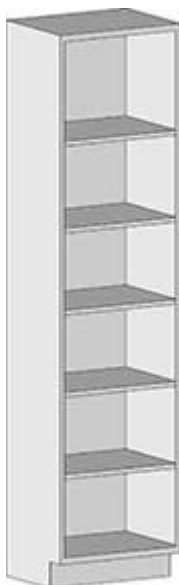

with flat top

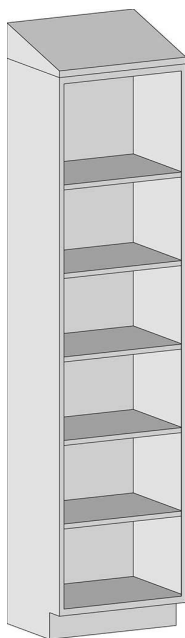

with sloped top

## Tall Cabinets— Open Tall Cases

### MODELS:

- |                                       |   |
|---------------------------------------|---|
| <input type="checkbox"/> SSC-TOB-1824 | <input type="checkbox"/> SSC-TOBST-1824 |
| <input type="checkbox"/> SSC-TOB-1830 | <input type="checkbox"/> SSC-TOBST-1830 |
| <input type="checkbox"/> SSC-TOB-1836 | <input type="checkbox"/> SSC-TOBST-1836 |
| <input type="checkbox"/> SSC-TOB-1848 | <input type="checkbox"/> SSC-TOBST-1848 |
| <input type="checkbox"/> SSC-TOB-2424 | <input type="checkbox"/> SSC-TOBST-2424 |
| <input type="checkbox"/> SSC-TOB-2430 | <input type="checkbox"/> SSC-TOBST-2430 |
| <input type="checkbox"/> SSC-TOB-2436 | <input type="checkbox"/> SSC-TOBST-2436 |
| <input type="checkbox"/> SSC-TOB-2448 | <input type="checkbox"/> SSC-TOBST-2448 |

### Design and Construction Features

- Type 304 stainless steel construction.
- Five intermediate shelves, adjustable on 3" (76mm) increments.
- Available with 18" or 24" (457 or 610mm) depth.
- Widths range from 18" to 48" (457 to 1219mm).
- Units with flat top are 84" (2134mm) high.
- Units with sloped top are 89" (2261mm) high.

### Options / Accessories

- Additional shelves
- Custom sizes

**CAUTION:** Tall cabinets present a tipping hazard if not properly installed. Proper installation requires these cabinets to be anchored to a wall or other cabinets to improve stability and ensure door operation.

### EAGLE GROUP

100 Industrial Boulevard  
 Clayton, DE 19938-8903 USA

Phone: 302-653-3000 • 800-441-8440

Fax: 302-653-2065

[www.eaglegrp.com](http://www.eaglegrp.com) • [www.eaglemhc.com](http://www.eaglemhc.com)

For custom configuration or fabrication needs, contact our **SpecFAB® Division**.

Phone: 302-653-3000 • Fax: 302-653-2065 • e-mail: [quotes@eaglegrp.com](mailto:quotes@eaglegrp.com)

### Certifications / Approvals



SEFA 8 Metal Casework

EG03.40 Rev. 11/21

Spec sheets available for viewing, printing or downloading from our online literature library at [www.eaglegrp.com](http://www.eaglegrp.com)

Item No.: \_\_\_\_\_  
 Project No.: \_\_\_\_\_  
 S.I.S. No.: \_\_\_\_\_

# Tall Cabinets—Open Tall Cases

## Units with Flat Top

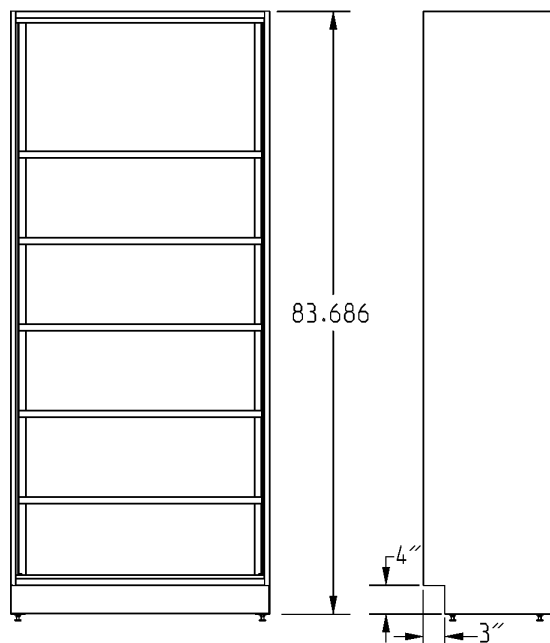
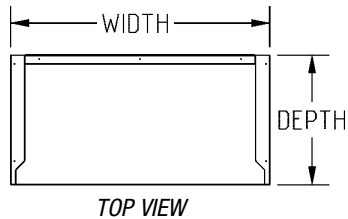

FRONT VIEW SIDE VIEW  
 (model #SSC-TOB-1836 shown)

## Units with Sloped Top

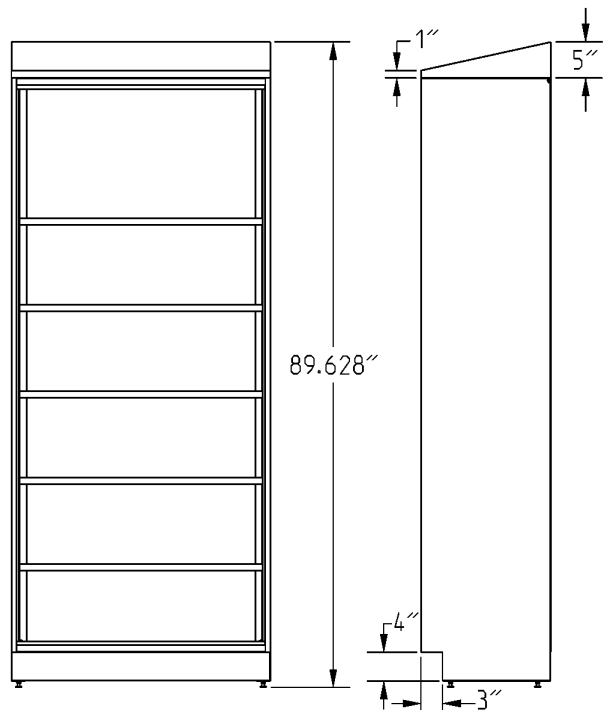
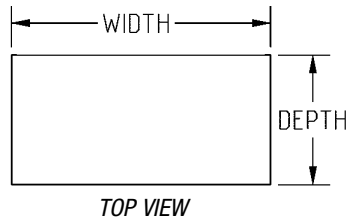

FRONT VIEW SIDE VIEW  
 (model #SSC-TOBST-1836 shown)

| depth |     | width |      | height |      | weight |       | model #      | with Sloped Top |        |     |       |                |
|-------|-----|-------|------|--------|------|--------|-------|--------------|-----------------|--------|-----|-------|----------------|
| in    | mm  | in    | mm   | in     | mm   | lbs.   | kg    |              | height          | weight |     |       |                |
| 18"   | 457 | 24"   | 610  | 84"    | 2134 | 263    | 119.3 | SSC-TOB-1824 | 89"             | 2261   | 283 | 128.3 | SSC-TOBST-1824 |
| 18"   | 457 | 30"   | 762  | 84"    | 2134 | 293    | 132.9 | SSC-TOB-1830 | 89"             | 2261   | 313 | 142.0 | SSC-TOBST-1830 |
| 18"   | 457 | 36"   | 914  | 84"    | 2134 | 301    | 136.5 | SSC-TOB-1836 | 89"             | 2261   | 321 | 145.6 | SSC-TOBST-1836 |
| 18"   | 457 | 48"   | 1218 | 84"    | 2134 | 331    | 150.1 | SSC-TOB-1848 | 89"             | 2261   | 351 | 159.2 | SSC-TOBST-1848 |
| 24"   | 610 | 24"   | 610  | 84"    | 2134 | 338    | 153.3 | SSC-TOB-2424 | 89"             | 2261   | 358 | 162.4 | SSC-TOBST-2424 |
| 24"   | 610 | 30"   | 762  | 84"    | 2134 | 368    | 166.9 | SSC-TOB-2430 | 89"             | 2261   | 388 | 176.0 | SSC-TOBST-2430 |
| 24"   | 610 | 36"   | 914  | 84"    | 2134 | 413    | 187.3 | SSC-TOB-2436 | 89"             | 2261   | 433 | 196.4 | SSC-TOBST-2436 |
| 24"   | 610 | 48"   | 1219 | 84"    | 2134 | 443    | 200.9 | SSC-TOB-2448 | 89"             | 2261   | 463 | 210.0 | SSC-TOBST-2448 |

**EAGLE GROUP**  
 100 Industrial Boulevard, Clayton, DE 19938-8903 USA  
 Phone: 302-653-3000 or 800-441-8440 • Fax: 302-653-2065  
 www.eaglegrp.com • www.eaglemhc.com

Printed in U.S.A.  
 ©2021 by Eagle Group  
 Rev. 11/21

Spec sheets available for viewing, printing or downloading from our online literature library at [www.eaglegrp.com](http://www.eaglegrp.com)

Although every attempt has been made to ensure the accuracy of the information provided, we cannot be held responsible for typographical or printing errors. Information and specifications are subject to change without notice. Please confirm at time of order.