

Ceiling-Mounted Pot Rack

ASSEMBLY INSTRUCTIONS

CAUTION

INSPECT CONTENTS IMMEDIATELY AND FILE CLAIM WITH DELIVERING CARRIER FOR ANY DAMAGE.
SAVE YOUR BOX AND ALL PACKING MATERIALS.
 YOU ARE RESPONSIBLE FOR DAMAGE TO YOUR UNIT IF RETURNED IMPROPERLY PACKED.

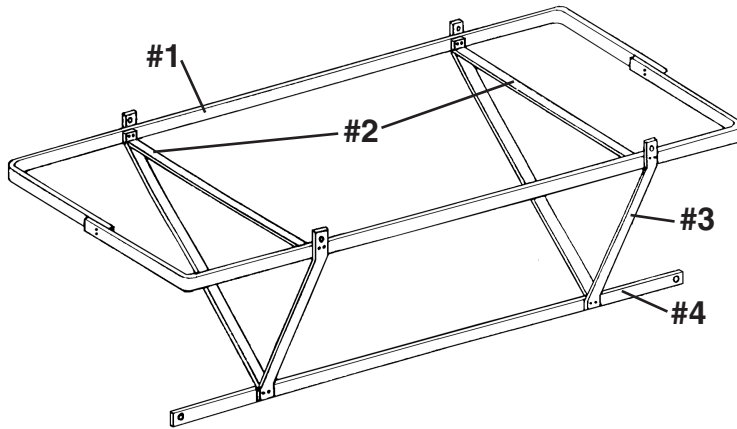

actual size of hardware:

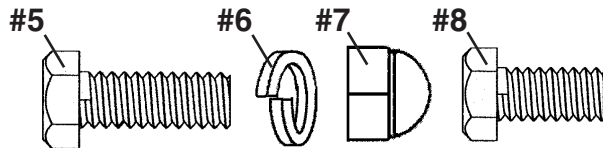

Parts List

#	qty	part #	description
#1	2	*	bar - top piece
#2	*	305669	cross top support
#3	*	305668	support
#4	1	*	bottom rack bar
#5	*	306136	hex head bolt 3/8-1"
#6	*	306122	lock washer, 3/8"
#7	*	306137	cap nut, 3/8"
#8	4	306138	hex cap bolt, 3/8"-3/4"

(not shown)

#9	*	306696	double pot hooks
#10	*	354886	S-hooks
#11	*	301260	chain

* Quantities and/or part numbers vary, depending on size.

Step 1 - Assemble top bar.

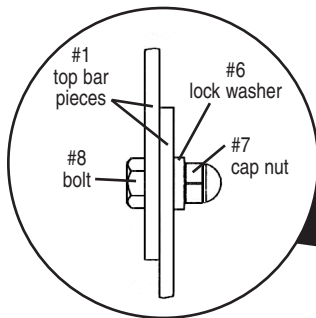

Step 2 - Attach cross top supports and bottom supports to top bar assembly.

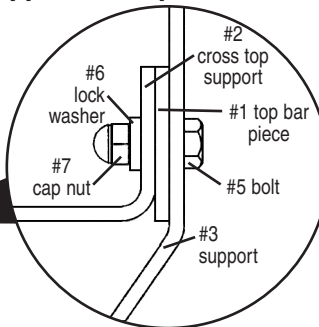

Step 3 - Attach bottom rack bar.

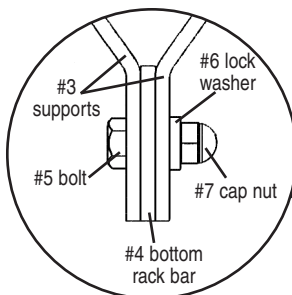

Step 4 - Install S-hooks and chain, then hang from ceiling.

Please note: Maximum workload capacity is 600 lbs.

EG9843 Revised 04/05



• 100 Industrial Boulevard, Clayton, Delaware 19938-8903 U.S.A. • www.eaglegrp.com
 • Phone: 302/653-3000 • (Foodservice) 800/441-8440 • (MHC/Retail) 800/637-5100
 • Fax: 302/653-2065 or 302/653-3036

Eagle Foodservice Equipment, Eagle MHC, SpecFAB, and Retail Display are divisions of Eagle Group. ©2005 by the Eagle Group